

Synagogue in Olkieniki

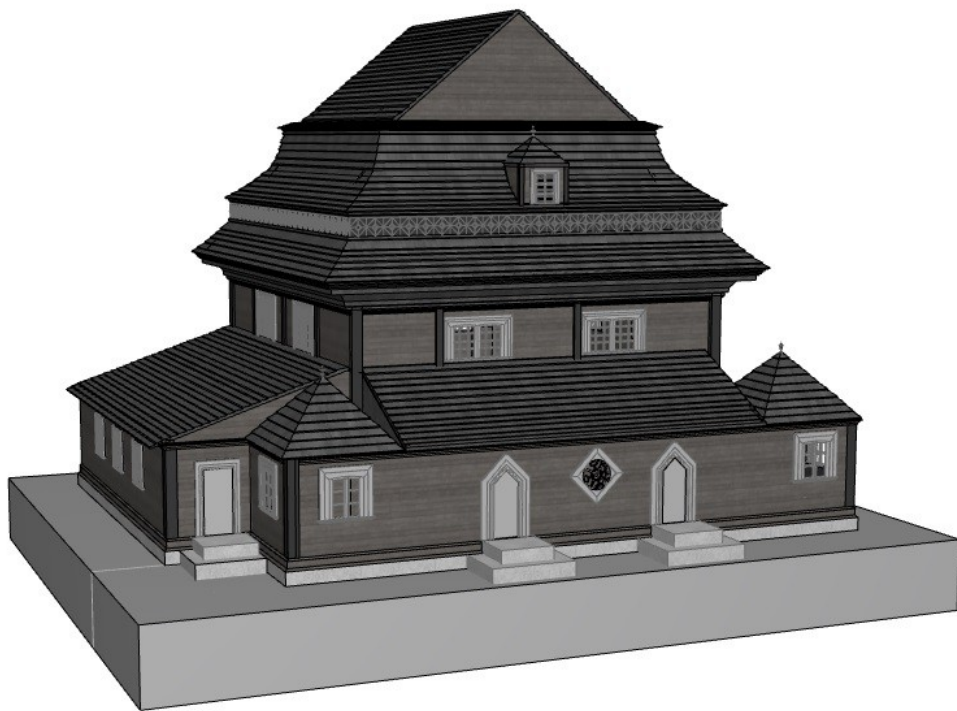

Description

A wooden synagogue located in Olkieniki, Lithuania. It was erected at the end of the 18th century by the Jewish community living in the area. It was destroyed during the first days of the occupation of Lithuania during World War II by the German Nazis in June 1941.

Scientific Advisor

Igor Bajena, Piotr Kuroczyński

Modelling

Milena Micun, Wiktoria Piasta

Cooperation Partnership

Warsaw University of Technology, University of Bologne, Hochschule Mainz

Used Software

ArchiCAD

Geo-coordinates

Latitude 54.358941 Longitude 24.841663

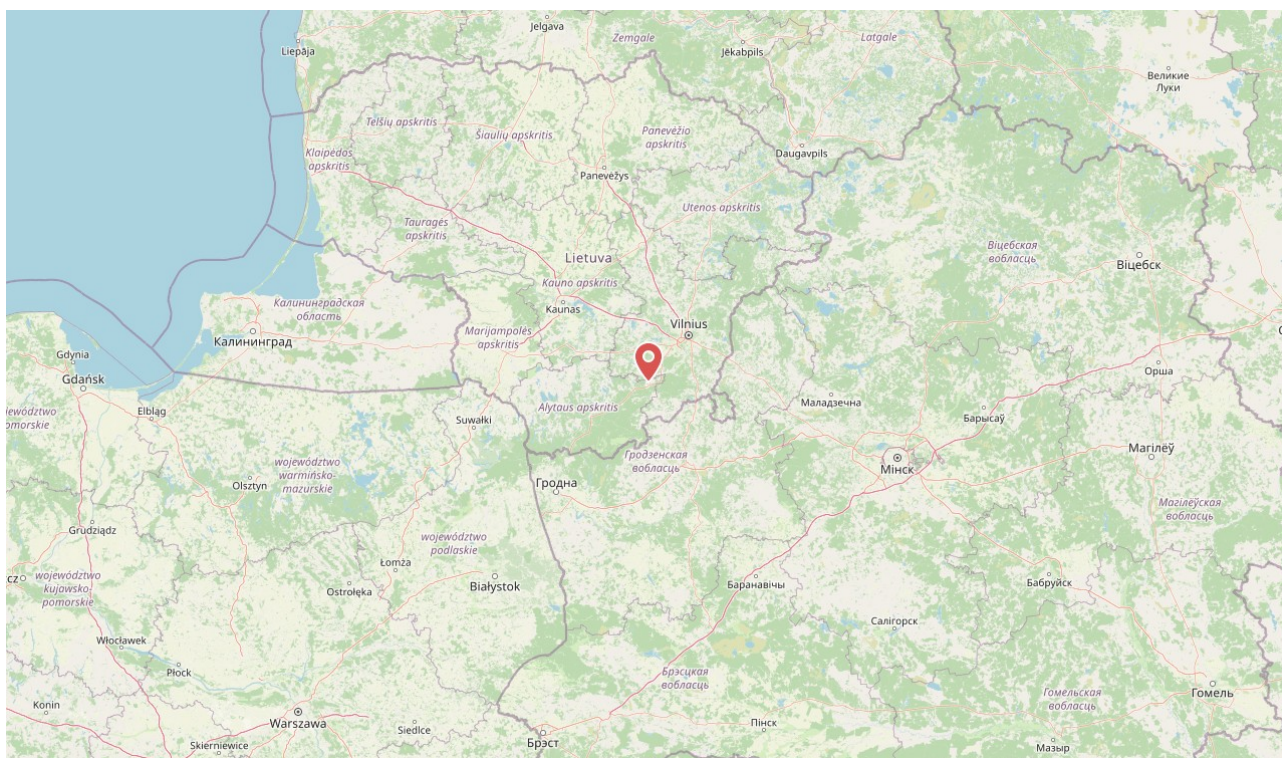
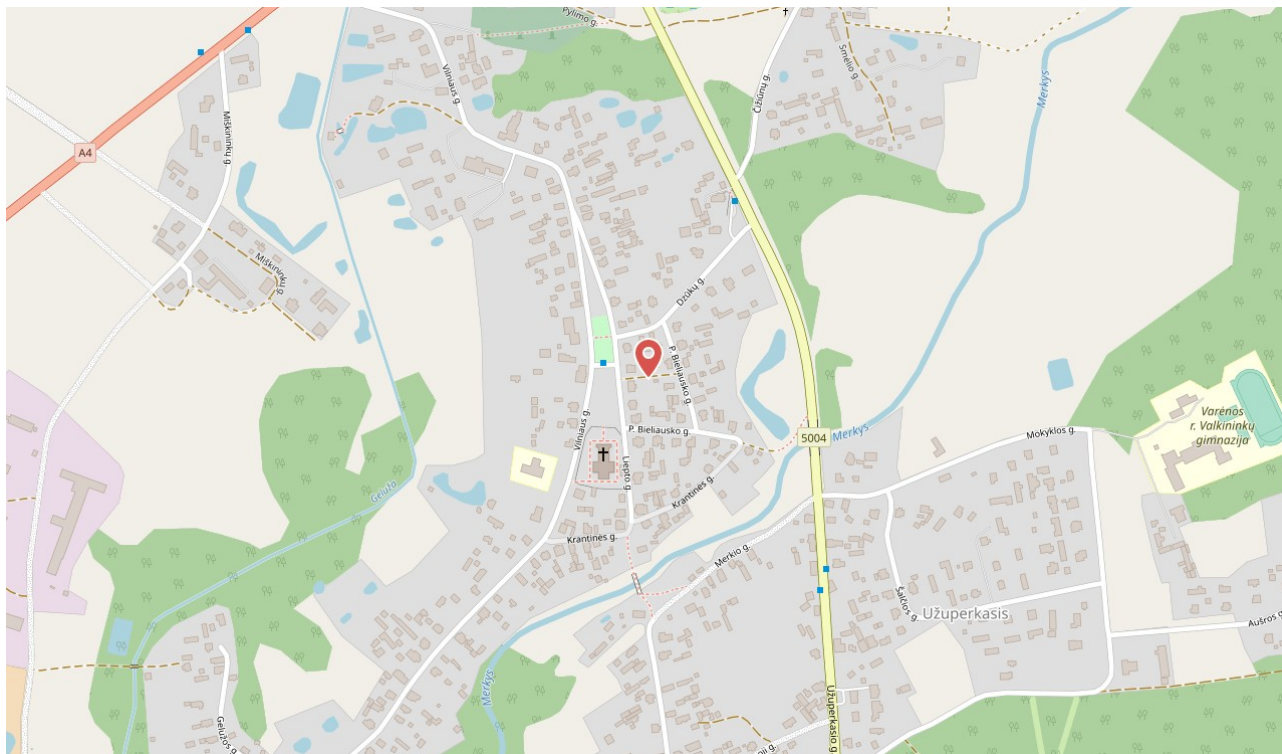

Truss Roofing

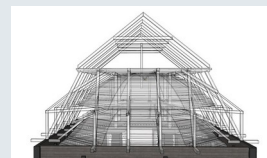

Working State: Final

Argumentation

Reconstruction

Sources

No reconstructions assigned

No sources assigned

First floor roofs



Working State: Final

Argumentation

Reconstruction

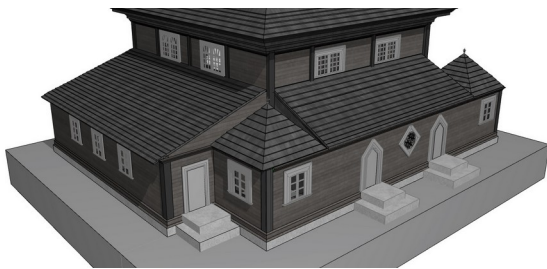

Fig. 53 2_first floor roofing_3D view.jpg

Sources

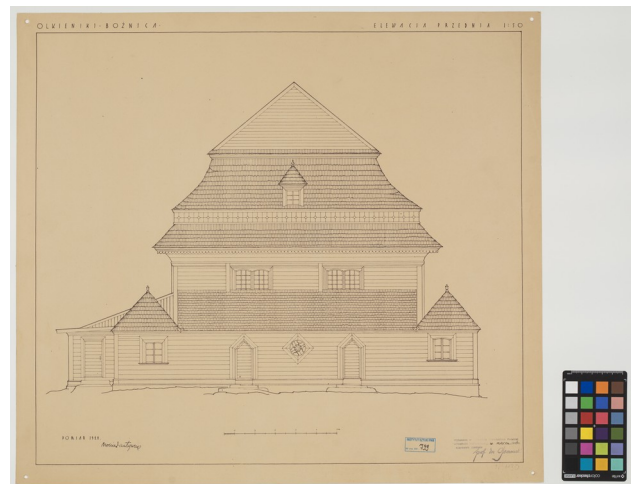

Fig. 1 IS_PAN_RP799_Olkieniki

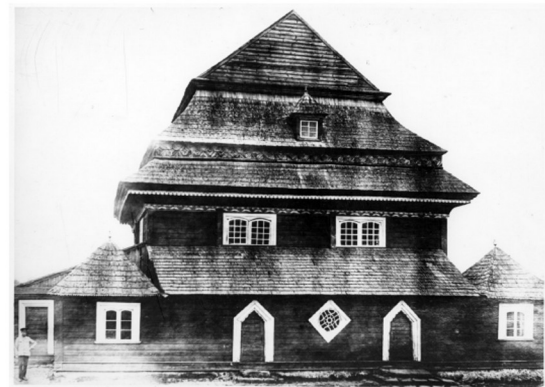

Fig. 12 528. Olkieniki. View from west



Fig. 13 529. Olkieni. View from the south-west

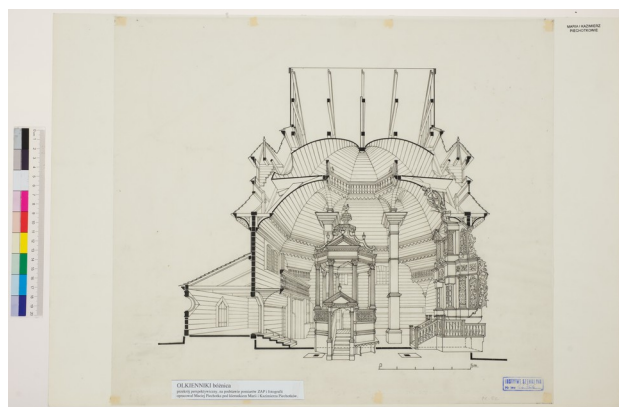

Fig. 5 IS_PAN_RP12706_Olkieni

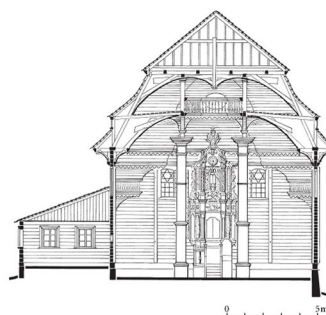

Fig. 6 533. Olkieni. Section looking towards the east wall

Working State: Work in progress

Argumentation

Reconstruction

Sources

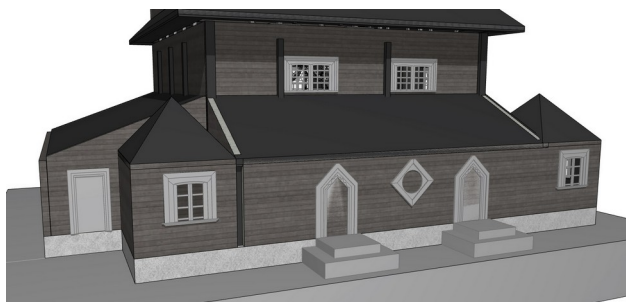

Fig. 24 First floor roofing_3D view

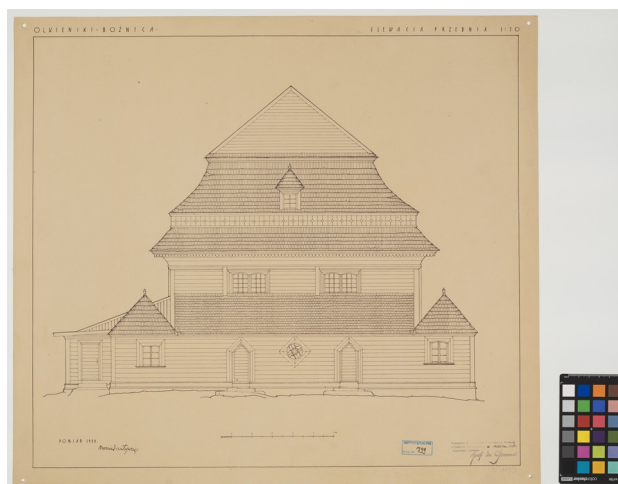

Fig. 1 IS_PAN_RP799_Olkieni

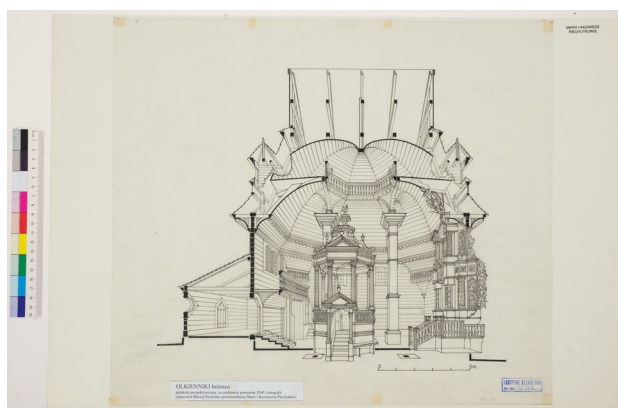

Fig. 5 IS_PAN_RP12706_Olkieni

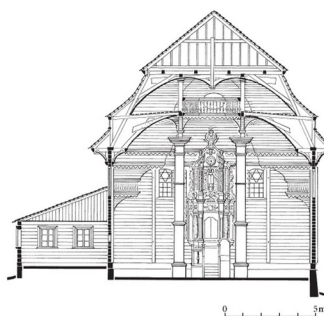

Fig. 6 533. Olkieni. Section looking towards the east wall

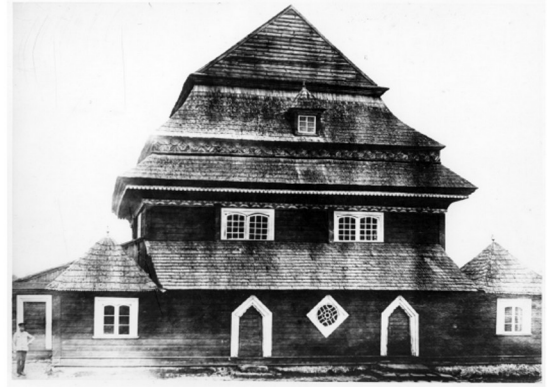

Fig. 12 528. Olkieni. View from west



Fig. 13 529. Olkieni. View from the south-west

Main hall roof



Working State: Final

Argumentation

Reconstruction

Sources

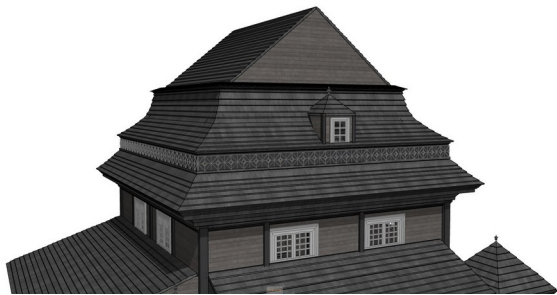

Fig. 49 2_main hall roof_3D view.jpg



Fig. 50 2_main hall roof_front view.jpg



Fig. 51 2_main hall roof_side view.jpg

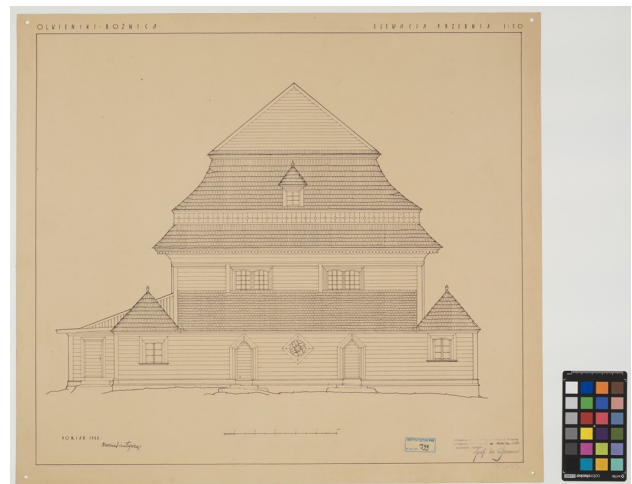

Fig. 1 IS_PAN_RP799_Olkieniki

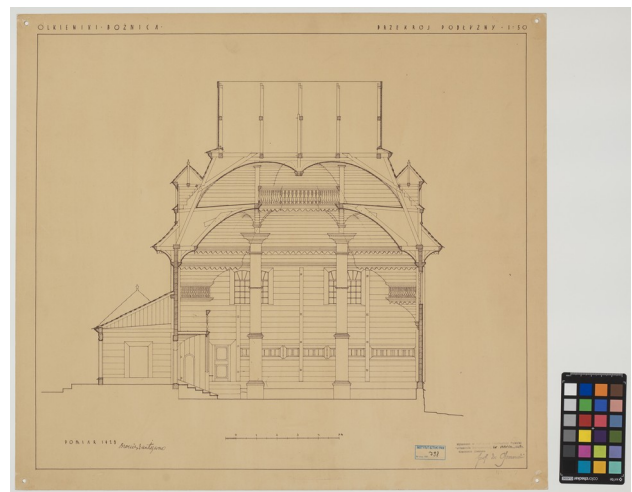

Fig. 4 IS_PAN_RP798_Olkieniki

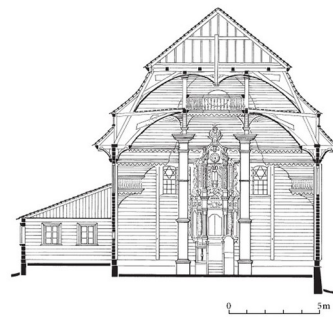

Fig. 6 533. Olkieniki. Section looking towards the east wall

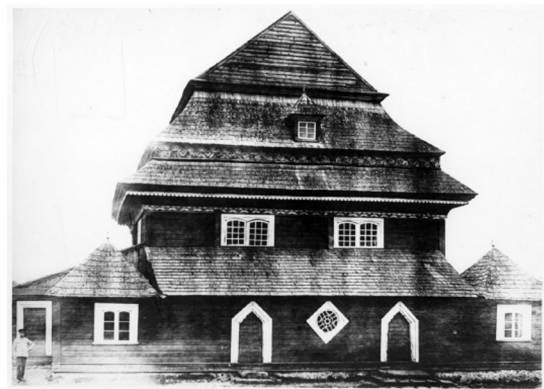

Fig. 12 528. Olkieniki. View from west



Fig. 13 529. Olkieniki. View from the south-west



Fig. 14 532. Olkieniki. View from the east

Working State: Work in progress

Argumentation

Reconstruction

Sources

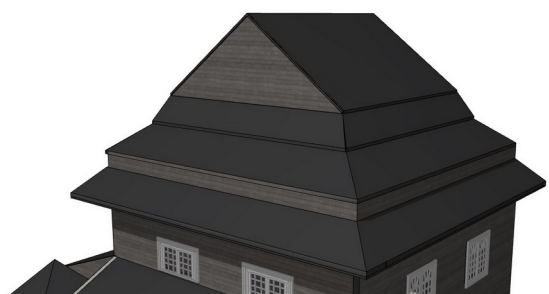

Fig. 20 Main hall roof_3D view



Fig. 21 Main hall roof_front view

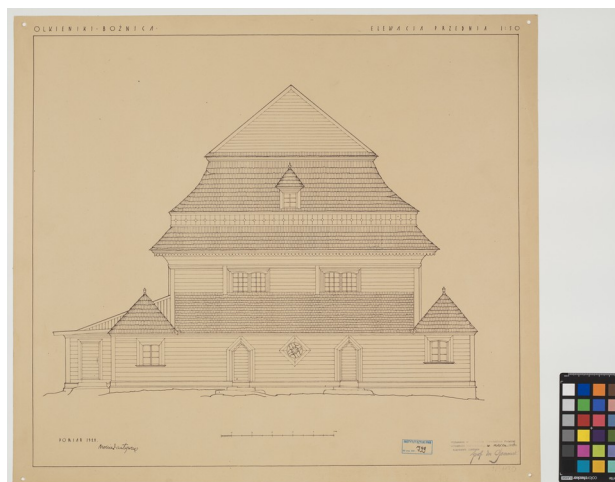

Fig. 1 IS_PAN_RP799_Olkieniki

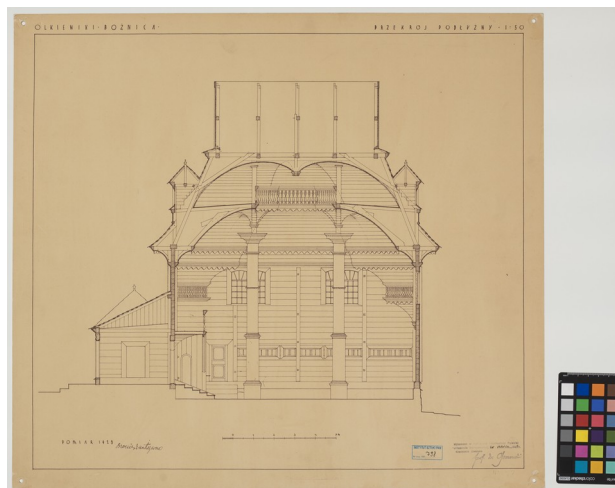



Fig. 22 Main hall roof_side view

Fig. 4 IS_PAN_RP798_Olkieniki

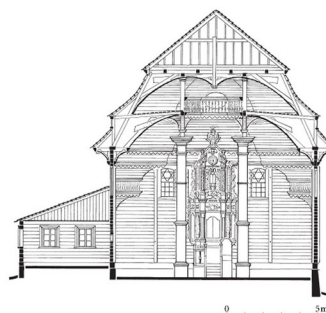

Fig. 6 533. Olkieniki. Section looking towards the east wall

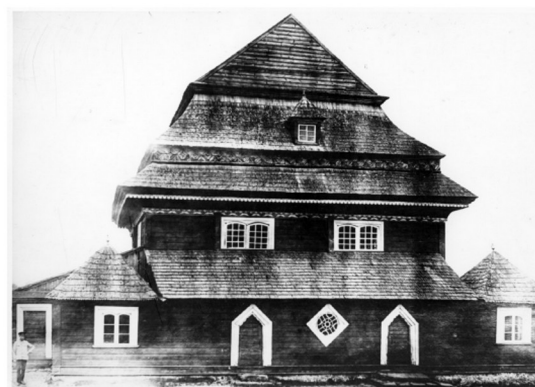

Fig. 12 528. Olkieniki. View from west



Fig. 13 529. Olkieniki. View from the south-west



Fig. 14 532. Olkieniki. View from the east

Load-bearing walls (main hall)

Working State: Final

Argumentation

Reconstruction

Sources



Fig. 56 2_section_with south wall in view.jpg

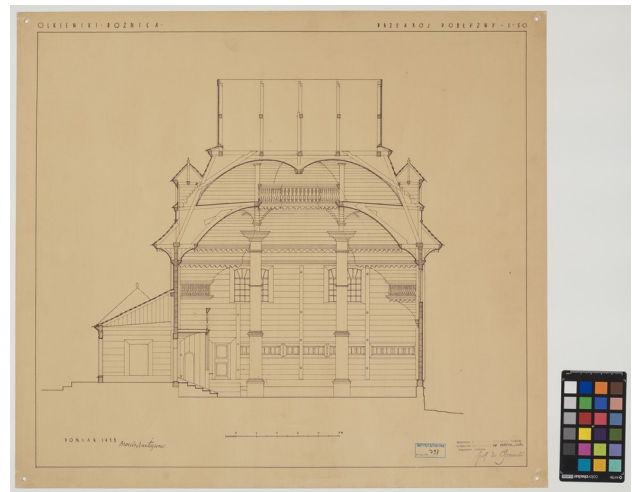

Fig. 4 IS_PAN_RP798_Olkieniki

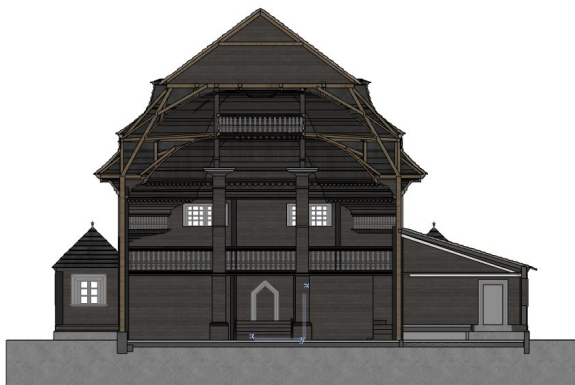

Fig. 57 2_section_with west wall in view.jpg

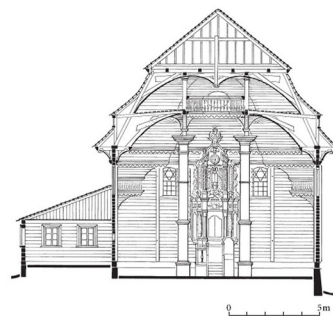

Fig. 6 533. Olkieniki. Section looking towards the east wall



Fig. 11 177,178. Olkieni, Bimah, before 1939



Fig. 14 532. Olkieni. View from the east

Load-bearing walls (vestibule)

Working State: Final

Argumentation

Reconstruction

Sources

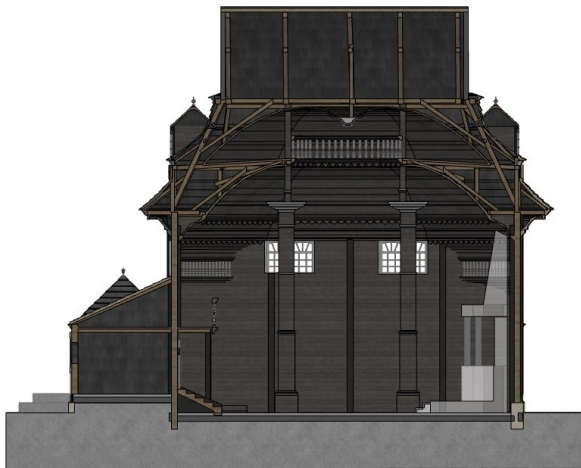

Fig. 56 2_section_with south wall in view.jpg



Fig. 57 2_section_with west wall in view.jpg

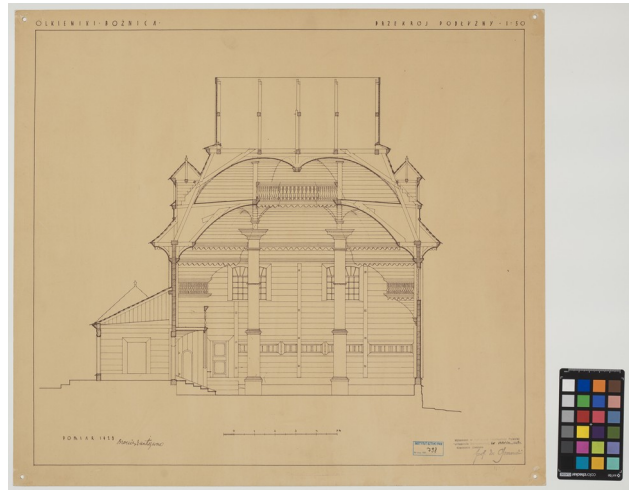

Fig. 4 IS_PAN_RP798_Olkieniki

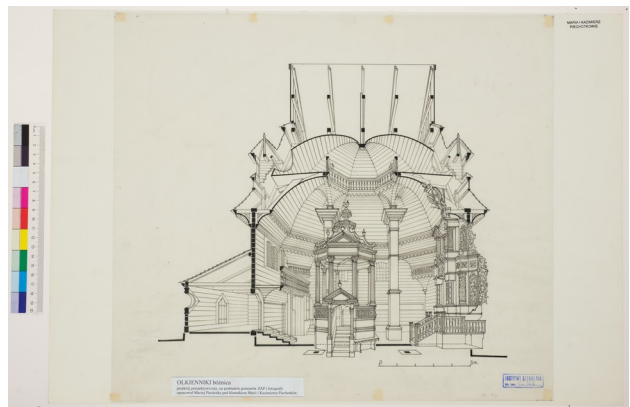

Fig. 5 IS_PAN_RP12706_Olkieniki

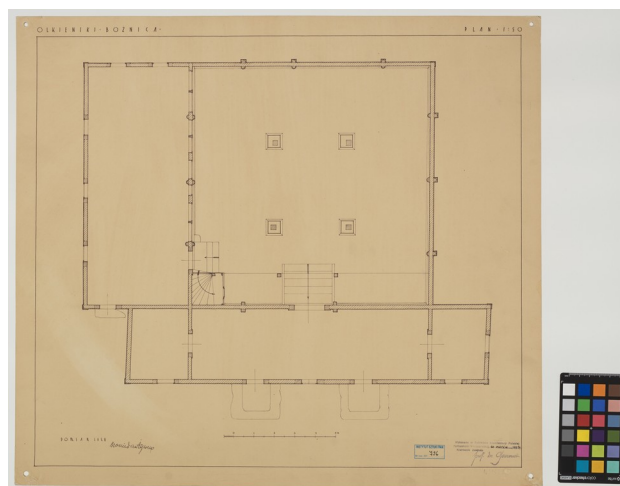

Fig. 2 IS_PAN_RP796_Olkieni

Columns



Working State: Work in progress

Argumentation

Reconstruction

Sources

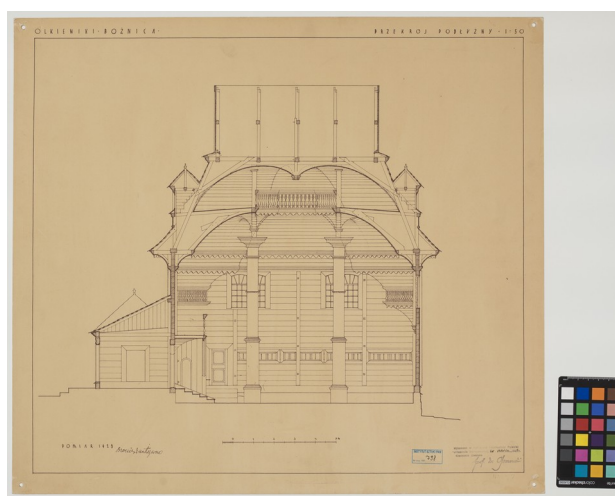
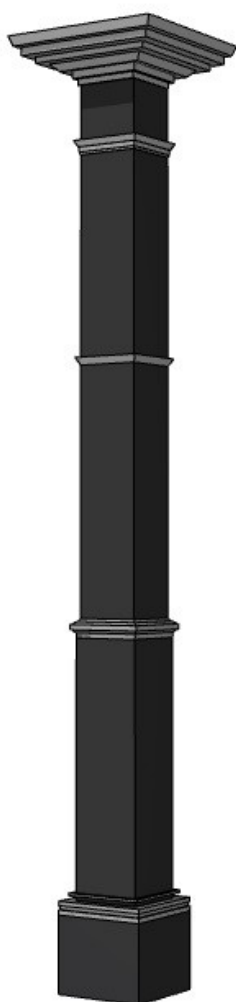

Fig. 4 IS_PAN_RP798_Olkieniki

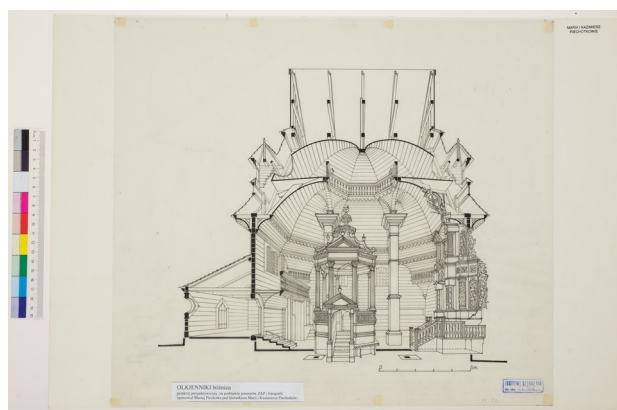

Fig. 5 IS_PAN_RP12706_Olkieniki

Fig. 30 Column

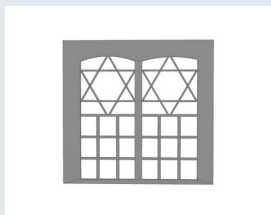

Fig. 8 74. Olkieni. Interior of the cupola



Fig. 11 177,178. Olkieni, Bimah, before 1939

Biforate windows



Working State: Final

Argumentation

Reconstruction

Sources

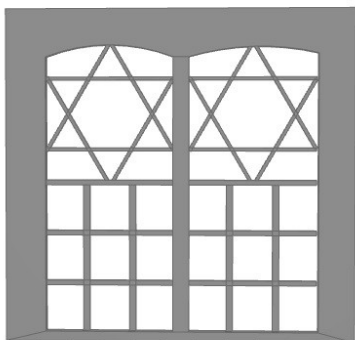

Fig. 34 biforate windows.jpg

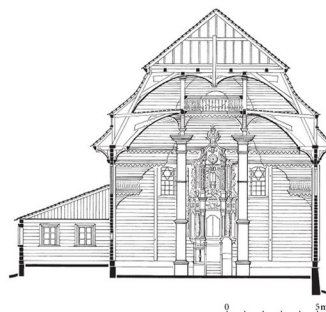

Fig. 6 533. Olkieniki. Section looking towards the east wall

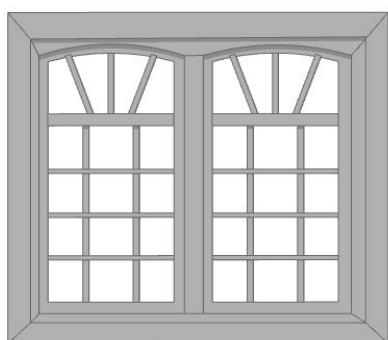

Fig. 47 biforate windows_2.jpg

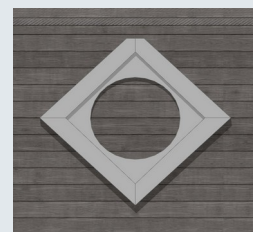

Fig. 9 127. Olkieni. Holy Ark, the upper section



Fig. 14 532. Olkieni. View from the east

Round windows



Working State: Final

Argumentation

Reconstruction

Sources

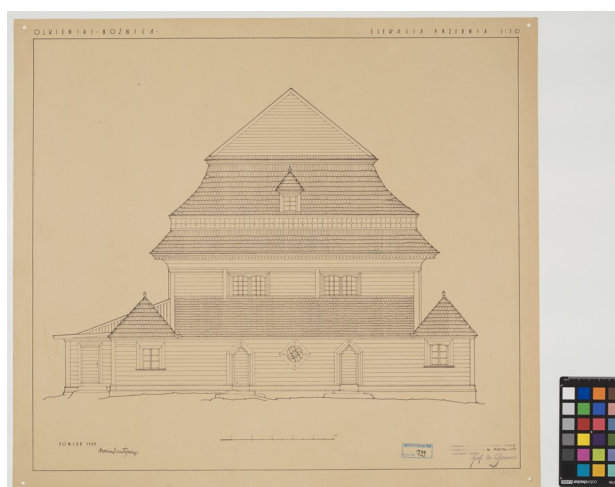
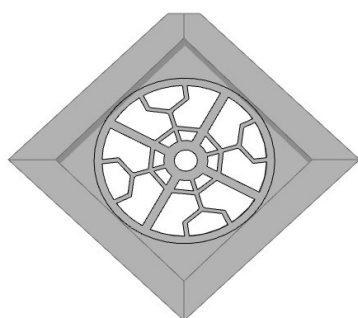

Fig. 1 IS_PAN_RP799_Olkieniki

Fig. 58 2_round window_front facade.jpg

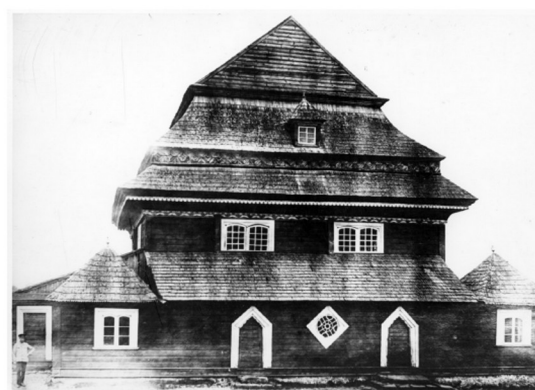

Fig. 12 528. Olkieniki. View from west

Working State: Work in progress

Argumentation

Reconstruction

Sources

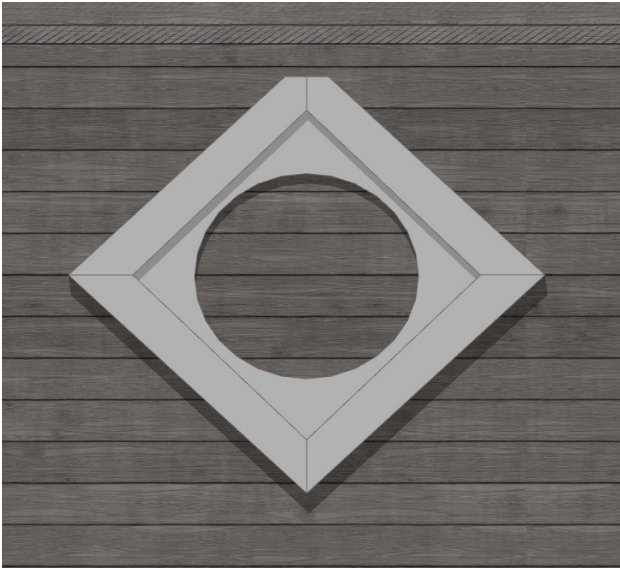

Fig. 32 Round window

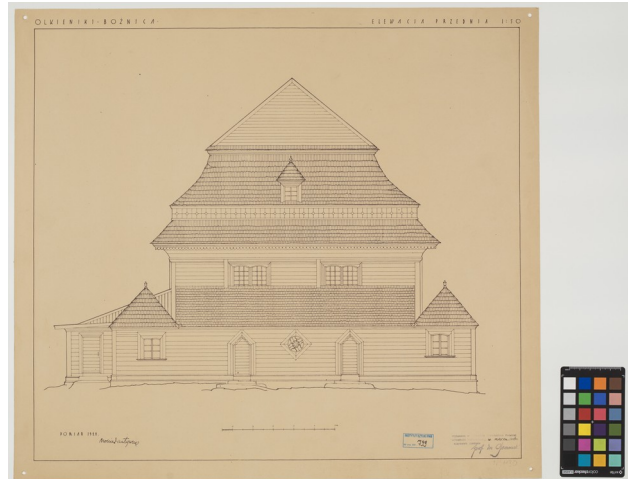

Fig. 1 IS_PAN_RP799_Olkieniki

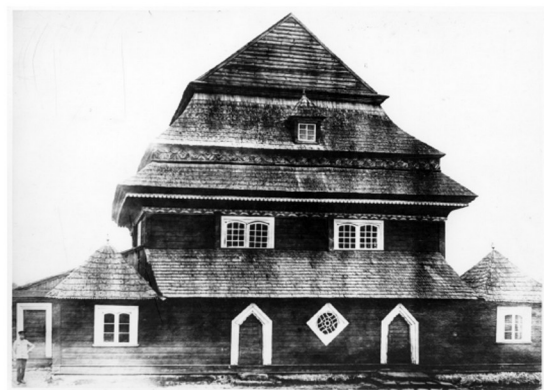

Fig. 12 528. Olkieniki. View from west

Rectangular windows

Working State: Final

Argumentation

Reconstruction

Sources



Fig. 36 Rectangular windows

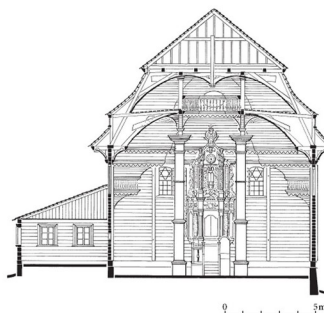
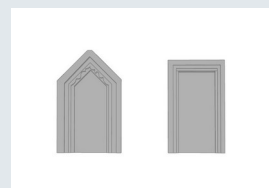

Fig. 6 533. Olkieniki. Section looking towards the east wall



Fig. 14 532. Olkieniki. View from the east

Doors



Working State: Final

Argumentation

Reconstruction

Sources

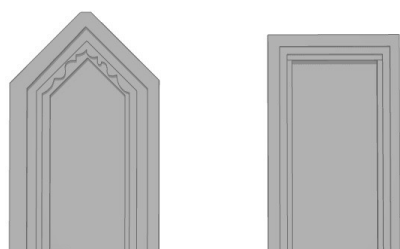

Fig. 37 Front door and other doors

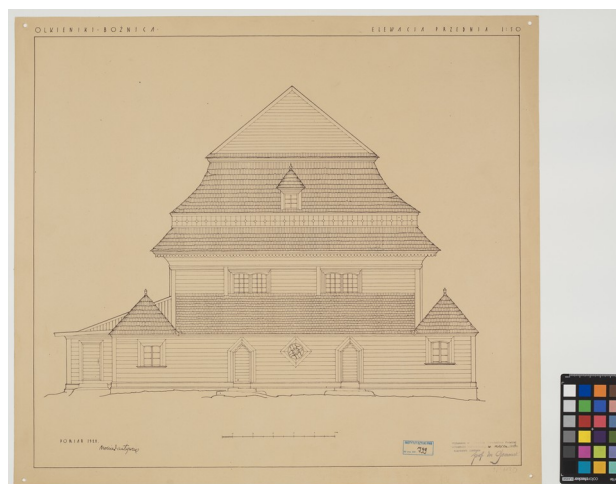

Fig. 1 IS_PAN_RP799_Olkieniki

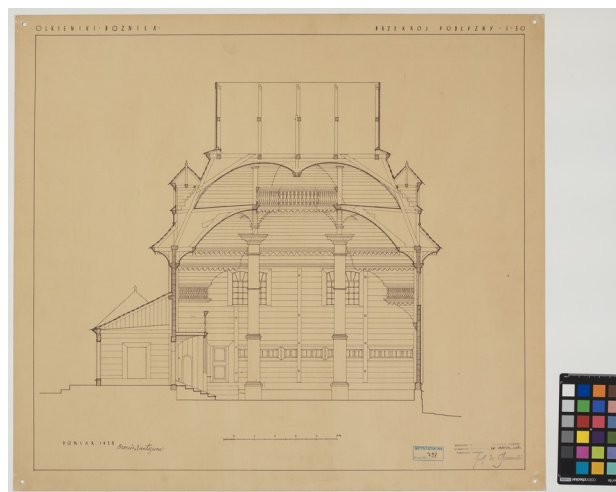

Fig. 4 IS_PAN_RP798_Olkieniki

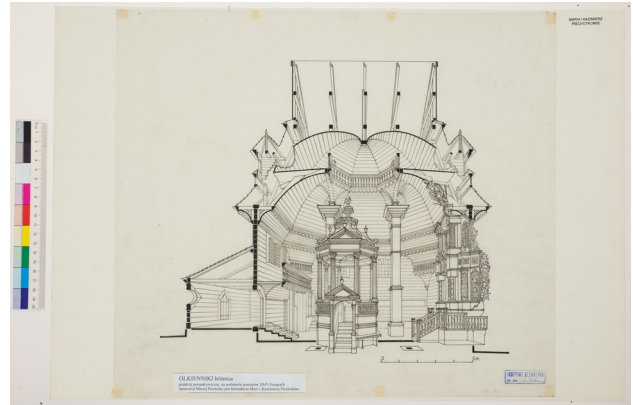

Fig. 5 IS_PAN_RP12706_Olkieniki

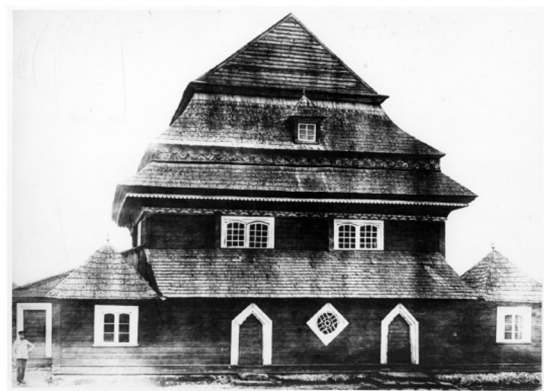

Fig. 12 528. Olkieniki. View from west

Stairs

Working State: Final

Argumentation

Reconstruction

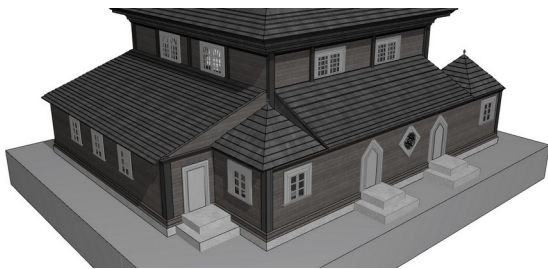

Fig. 53 2_first floor roofing_3D view.jpg



Fig. 57 2_section_with west wall in view.jpg

Sources

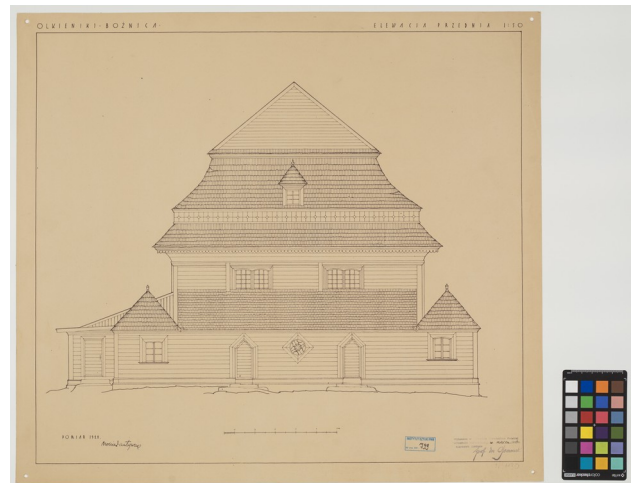

Fig. 1 IS_PAN_RP799_Olkieniki

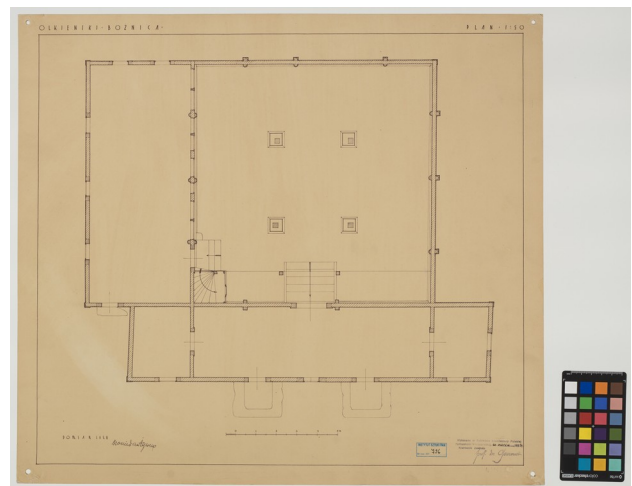

Fig. 2 IS_PAN_RP796_Olkieniki

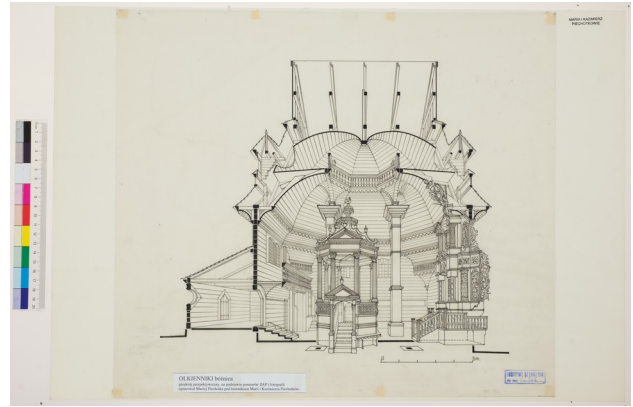
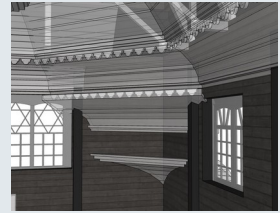

Fig. 5 IS_PAN_RP12706_Olkieniki

Squinches



Working State: Final

Argumentation

Reconstruction

Sources

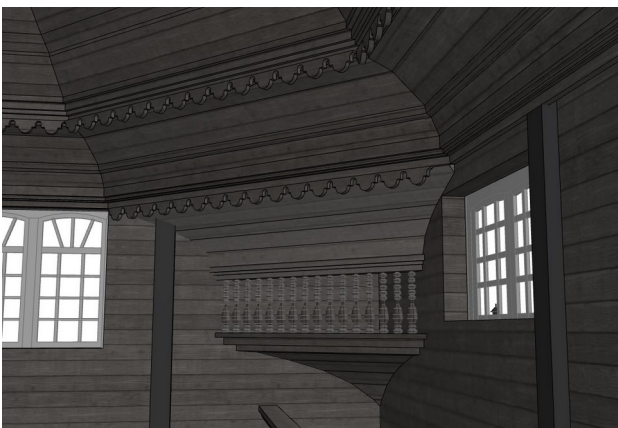

Fig. 59 2_squinches_3D view.jpg

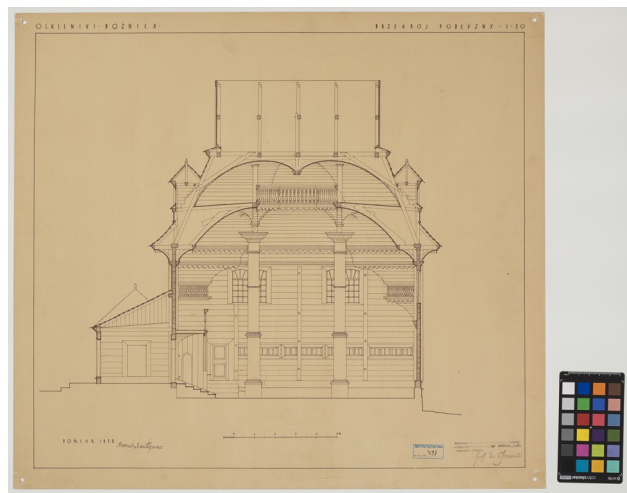

Fig. 4 IS_PAN_RP798_Olkieniki

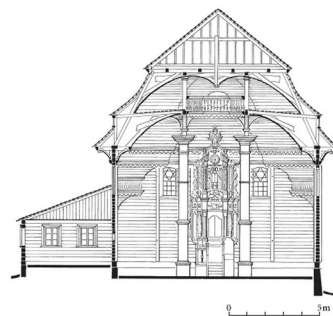

Fig. 6 533. Olkieniki. Section looking towards the east wall



Fig. 10 128. Olkieniki. Holy Ark, the lower section

Working State: Work in progress

Argumentation

Reconstruction

Sources

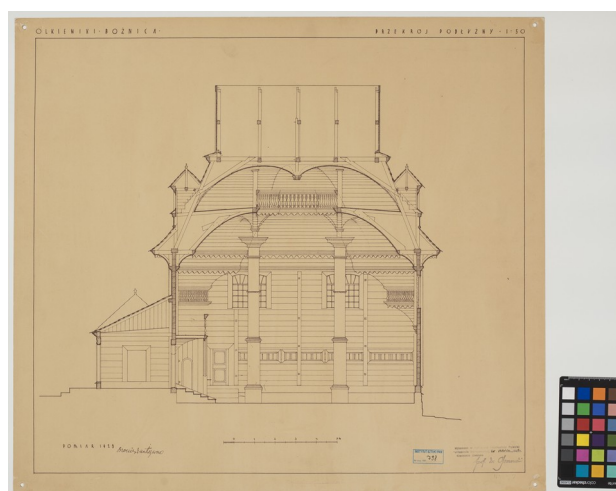
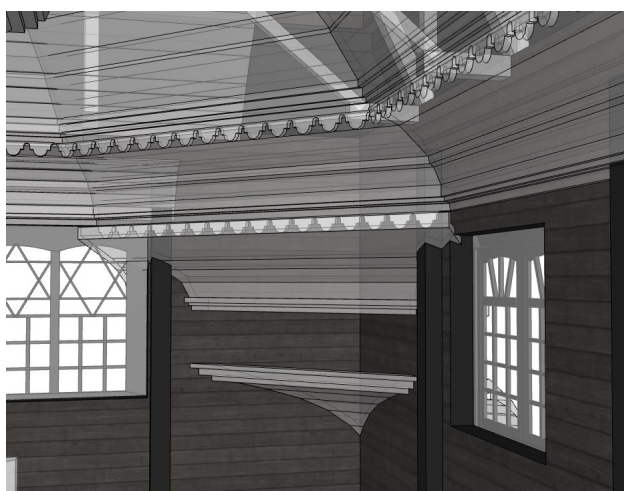

Fig. 41 Squinches_3D view

Fig. 4 IS_PAN_RP798_Olkieniki

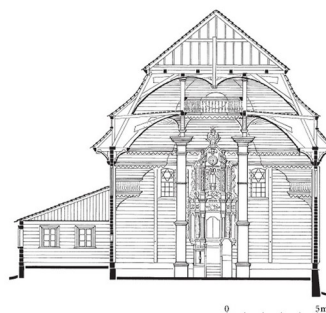

Fig. 6 533. Olkieniki. Section looking towards the east wall



Fig. 10 128. Olkieniki. Holy Ark, the lower section

Balustrades and railings



Working State: Final

Argumentation

Reconstruction



Fig. 42 Balustrades and railings

Sources

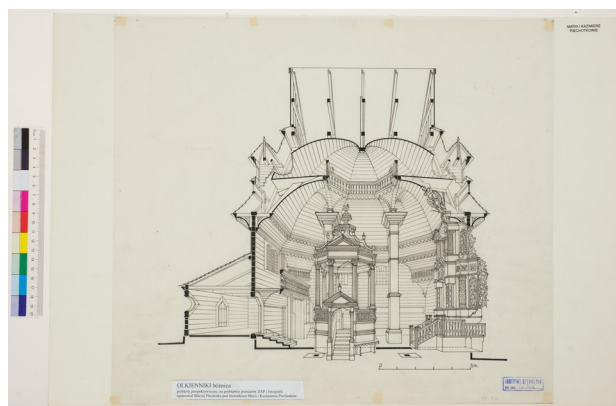

Fig. 5 IS_PAN_RP12706_Olkieniki



Fig. 8 74. Olkieniki. Interior of the cupola

Friezes



Working State: Final

Argumentation

Reconstruction



Fig. 60 2_Friezes.jpg

Sources

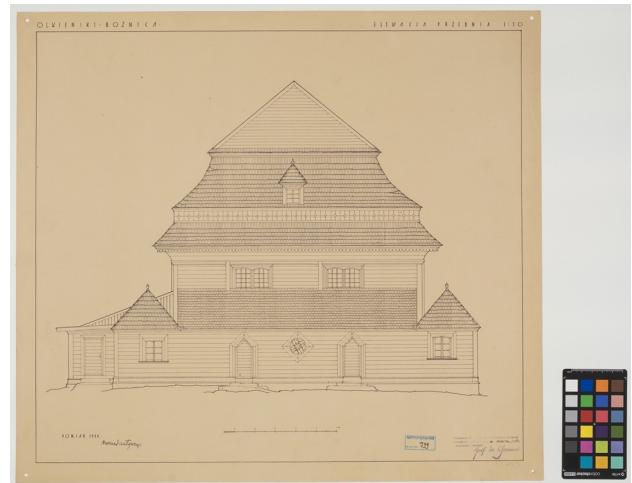

Fig. 1 IS_PAN_RP799_Olkieniki

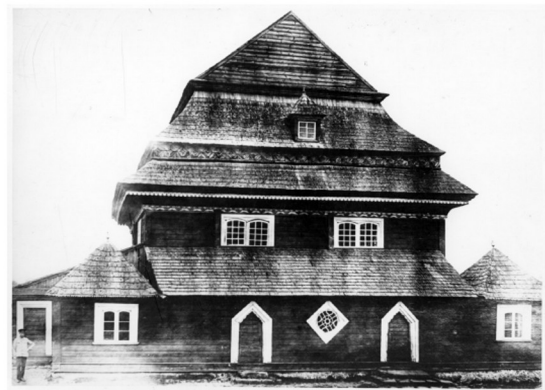

Fig. 12 528. Olkieniki. View from west



Fig. 14 532. Olkieni. View from the east

Working State: Work in progress

Argumentation

Reconstruction

Sources



Fig. 45 Friezes

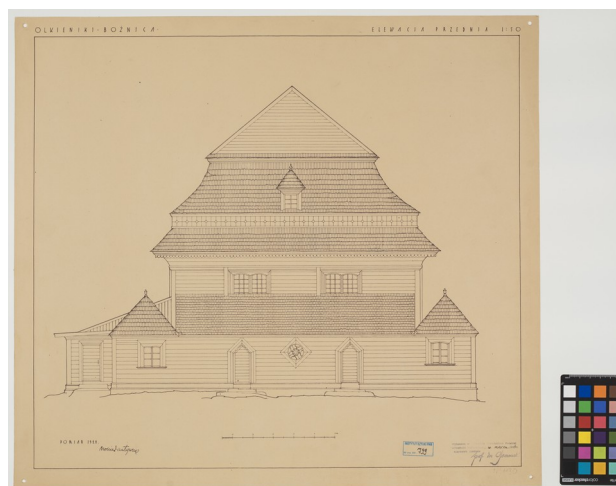

Fig. 1 IS_PAN_RP799_Olkieni

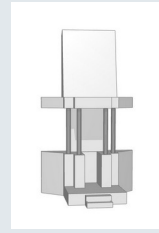

Fig. 12 528. Olkieni. View from west



Fig. 13 529. Olkieniki. View from the south-west

Holy Ark



Working State: Work in progress

Argumentation

Reconstruction

Sources

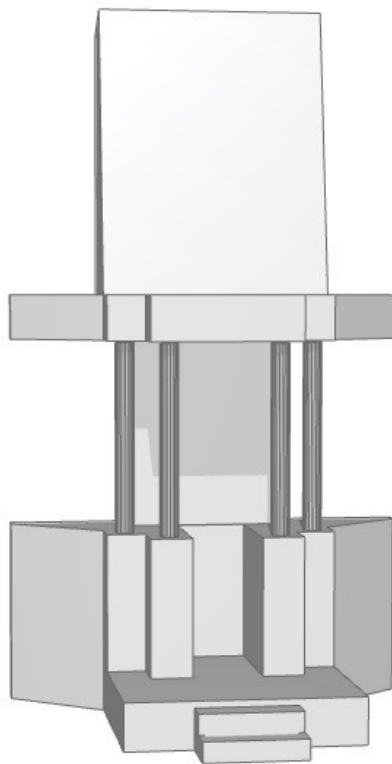

Fig. 39 Simplified Holy Ark

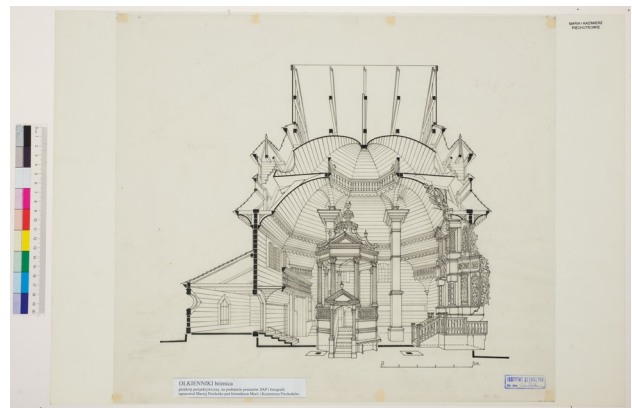

Fig. 5 IS_PAN_RP12706_Olkieni

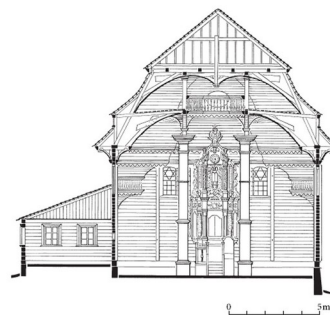

Fig. 6 533. Olkieni. Section looking towards the east wall



Fig. 9 127. Olkieni. Holy Ark, the upper section



Fig. 10 128. Olkieniki. Holy Ark, the lower section

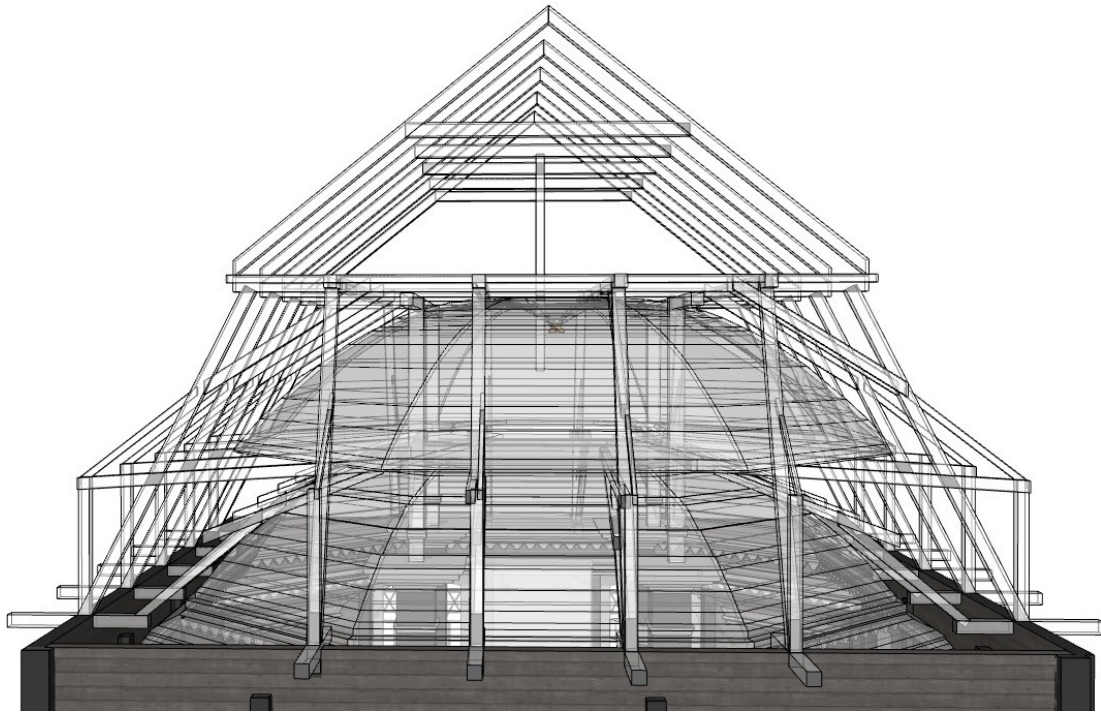

Fig. 17 Truss roofing_front view

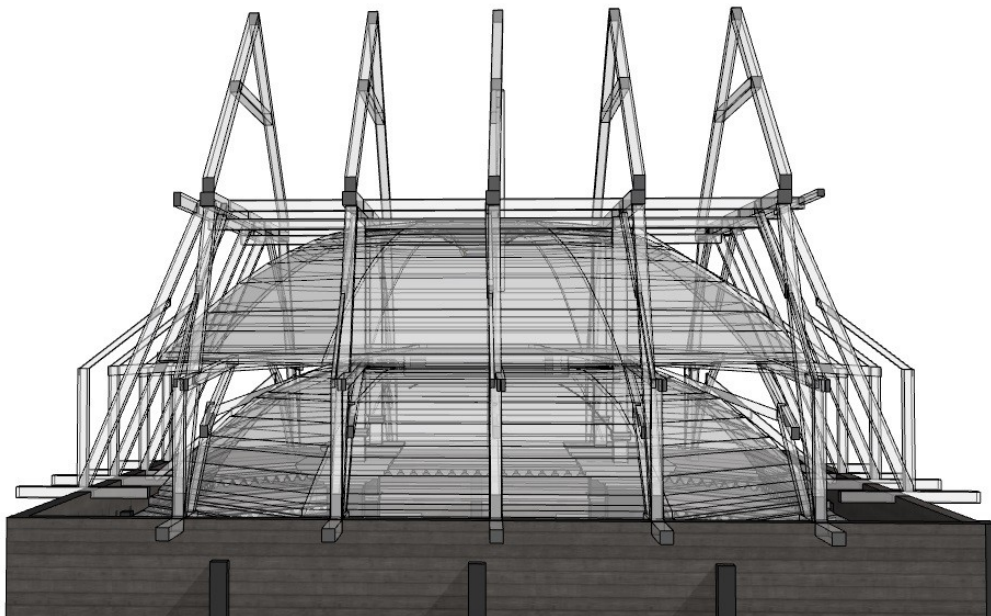

Fig. 18 Truss roofing_side view



Fig. 20 Main hall roof_3D view

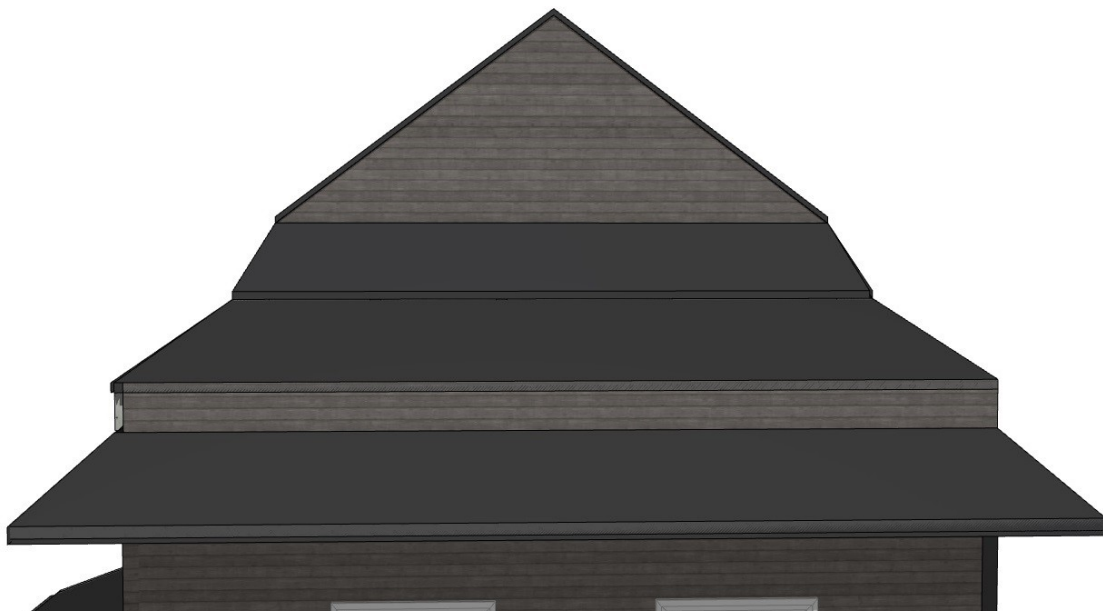

Fig. 21 Main hall roof_front view



Fig. 22 Main hall roof_side view

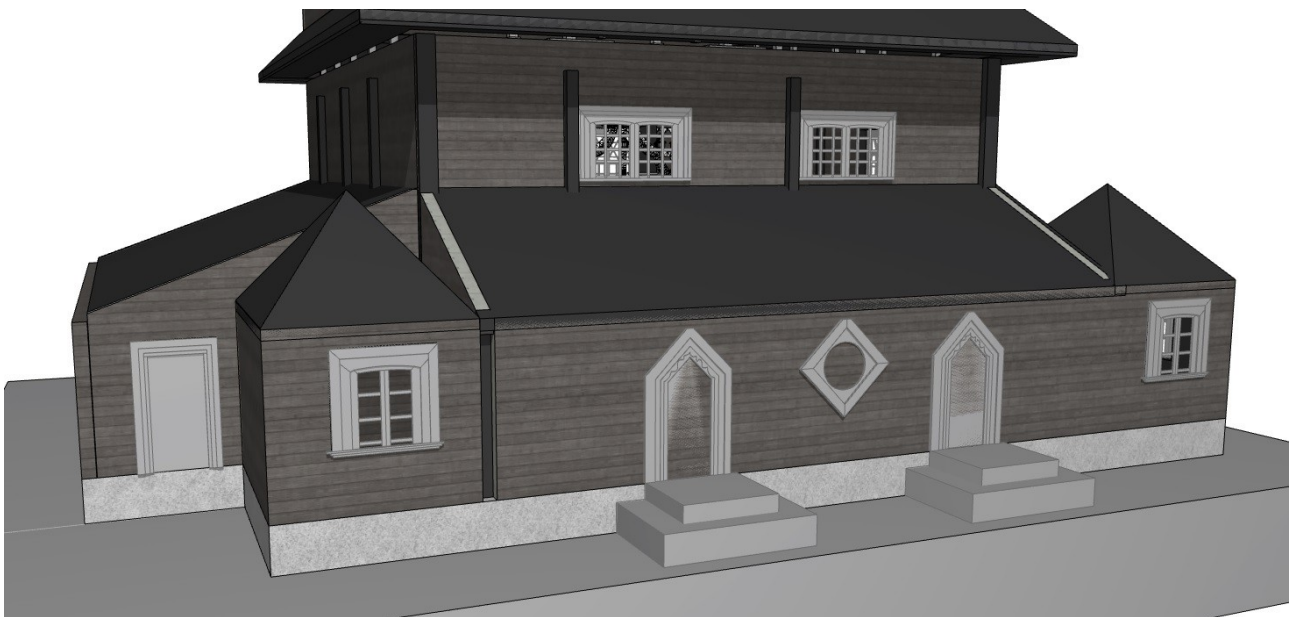

Fig. 24 First floor roofing_3D view

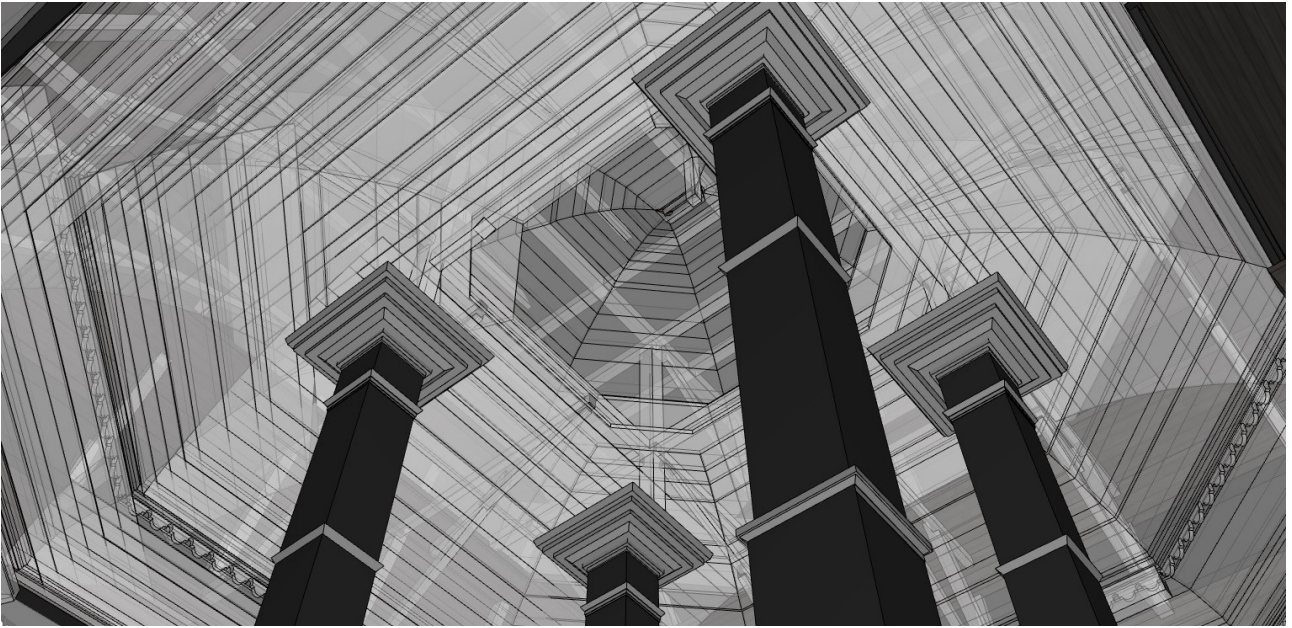

Fig. 26 Vault_view

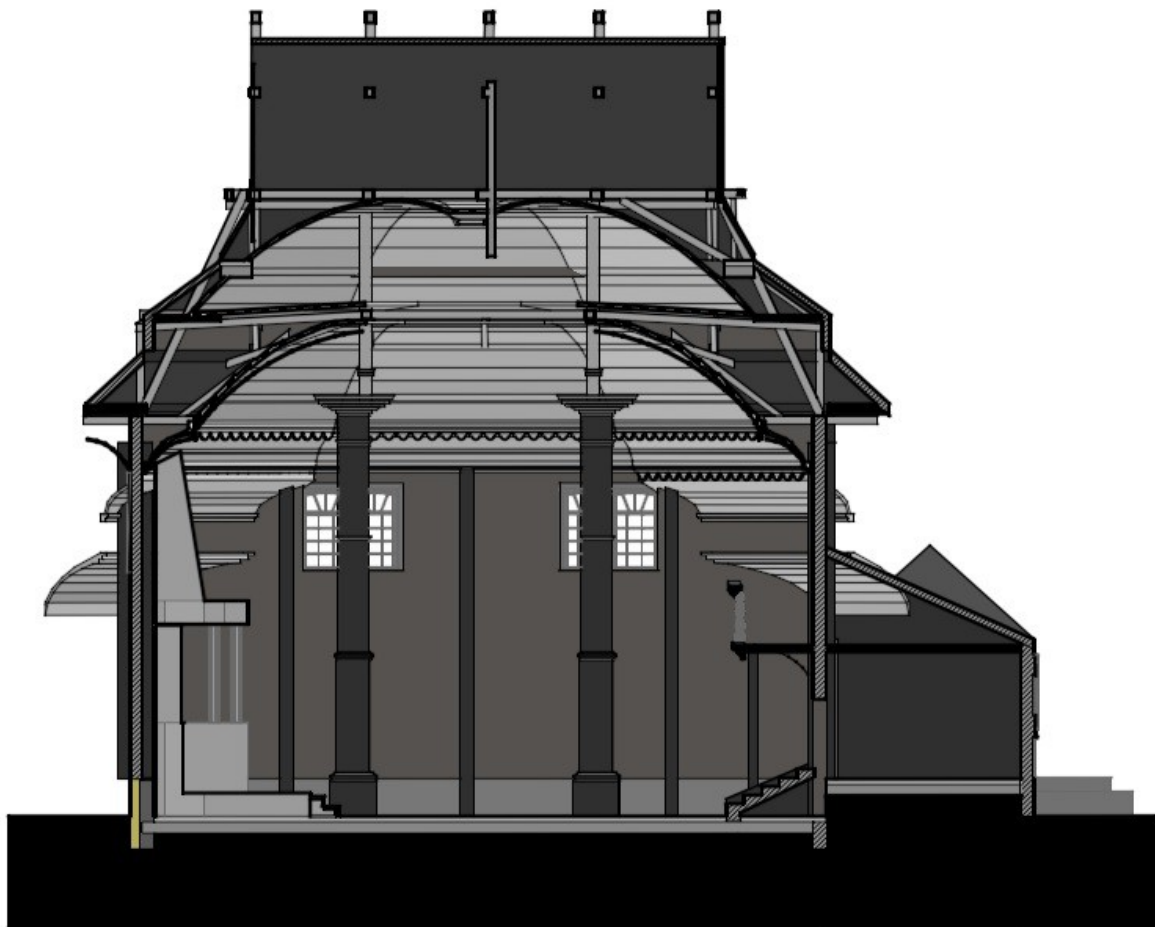

Fig. 27 section_with south wall in view.jpg



Fig. 28 section_with west wall in view.jpg



Fig. 30 Column

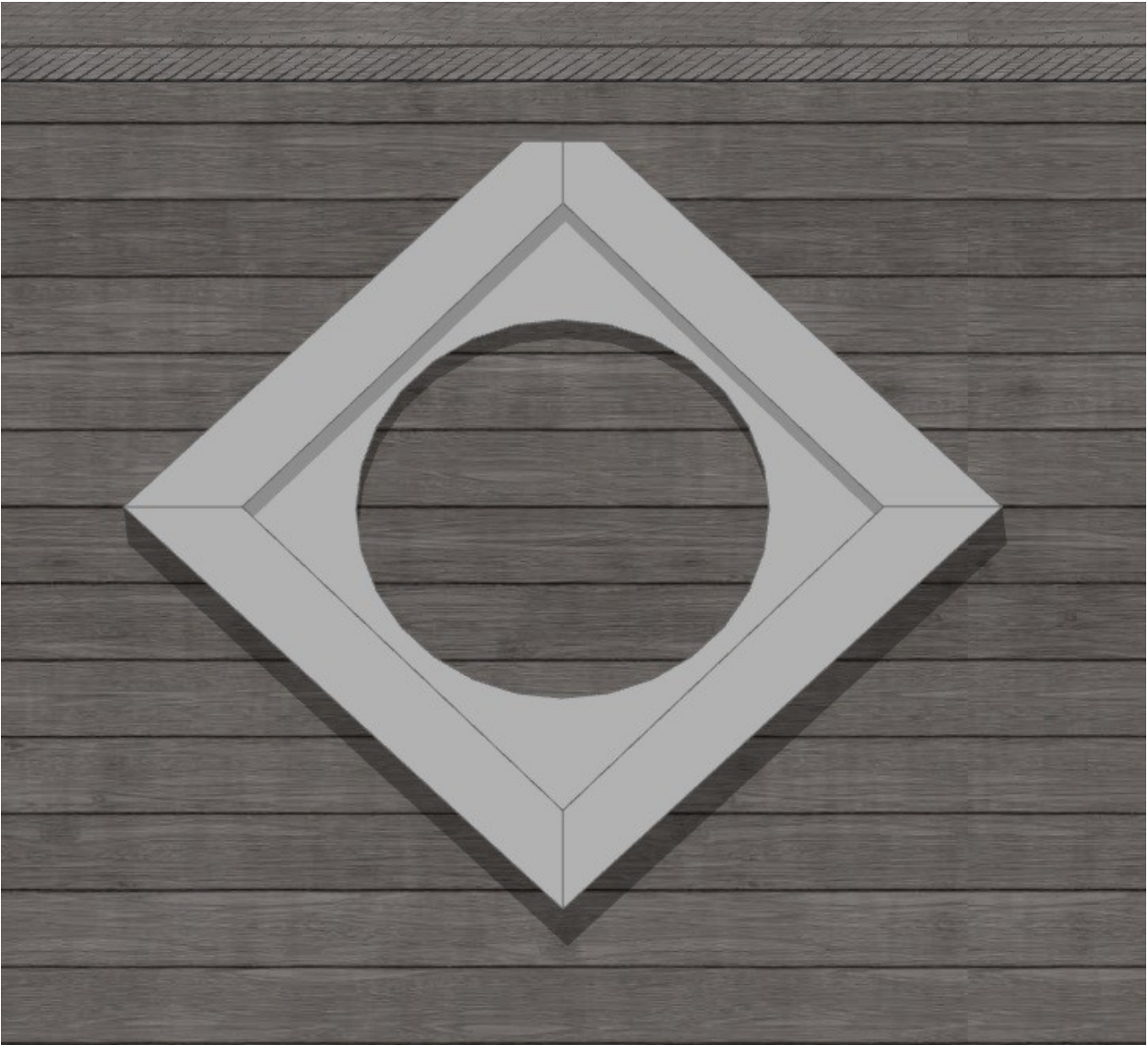

Fig. 32 Round window

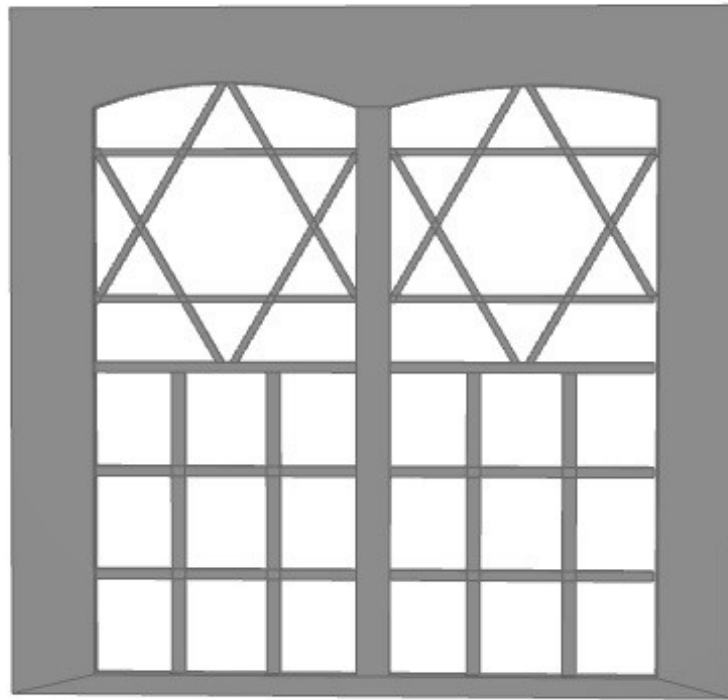

Fig. 34 bifold windows.jpg



Fig. 36 Rectangular windows

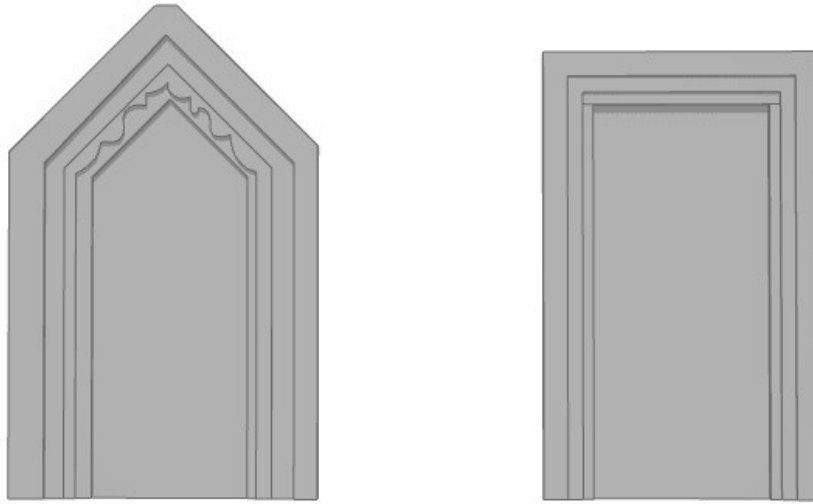

Fig. 37 Front door and other doors

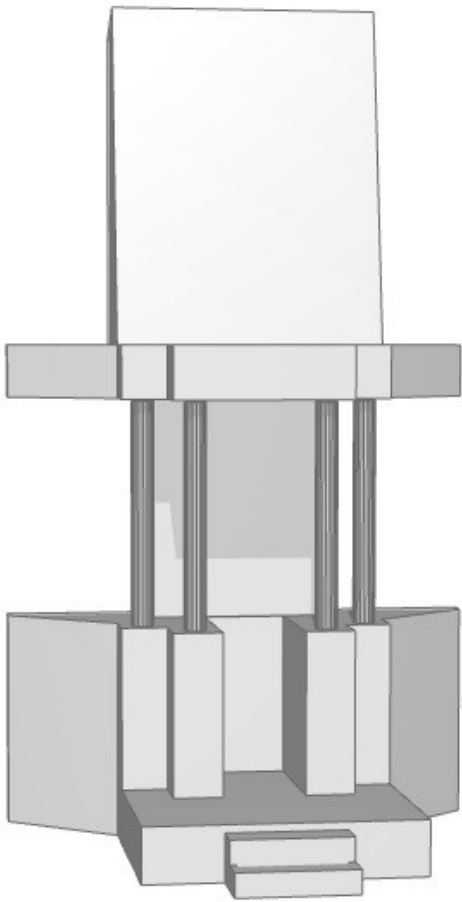

Fig. 39 Simplified Holy Ark

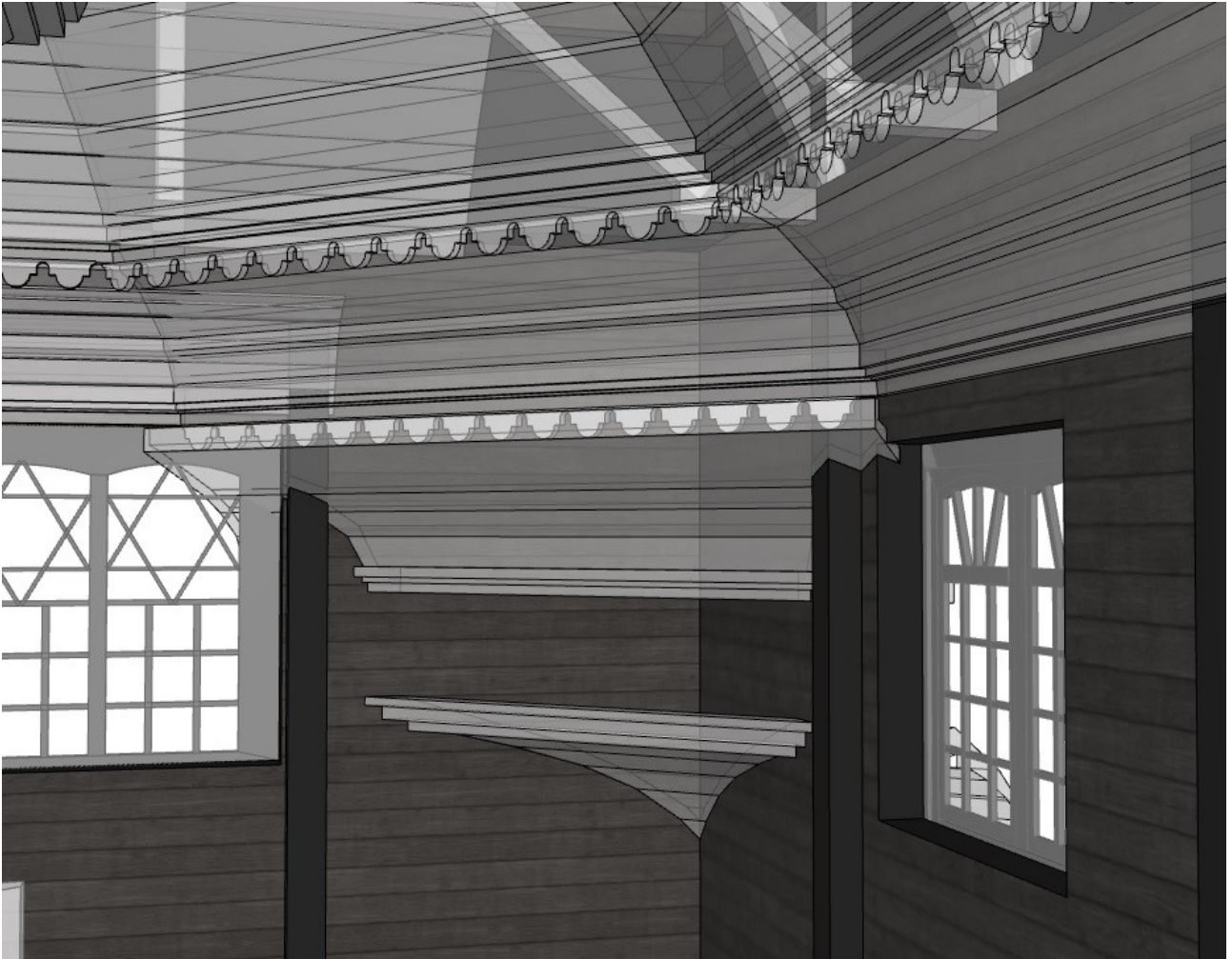

Fig. 41 Squinches_3D view



Fig. 42 Balustrades and railings



Fig. 45 Friezes

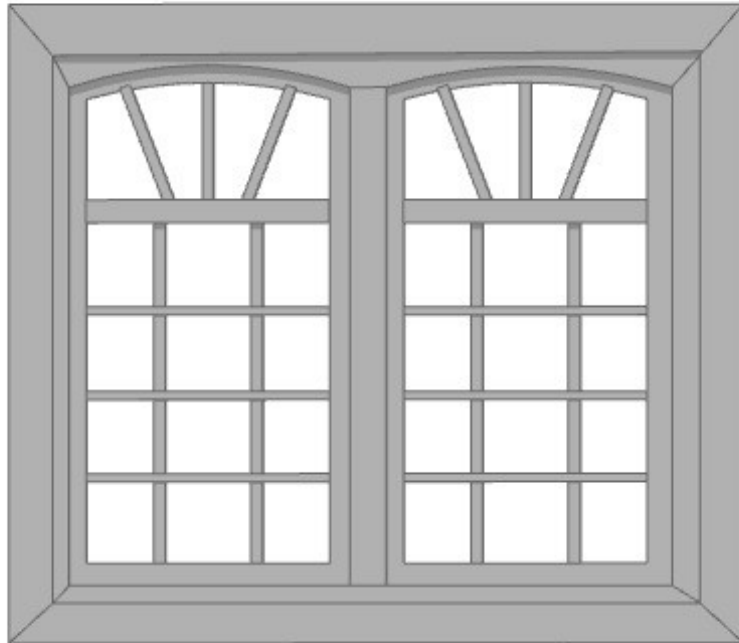

Fig. 47 biforate windows_2.jpg

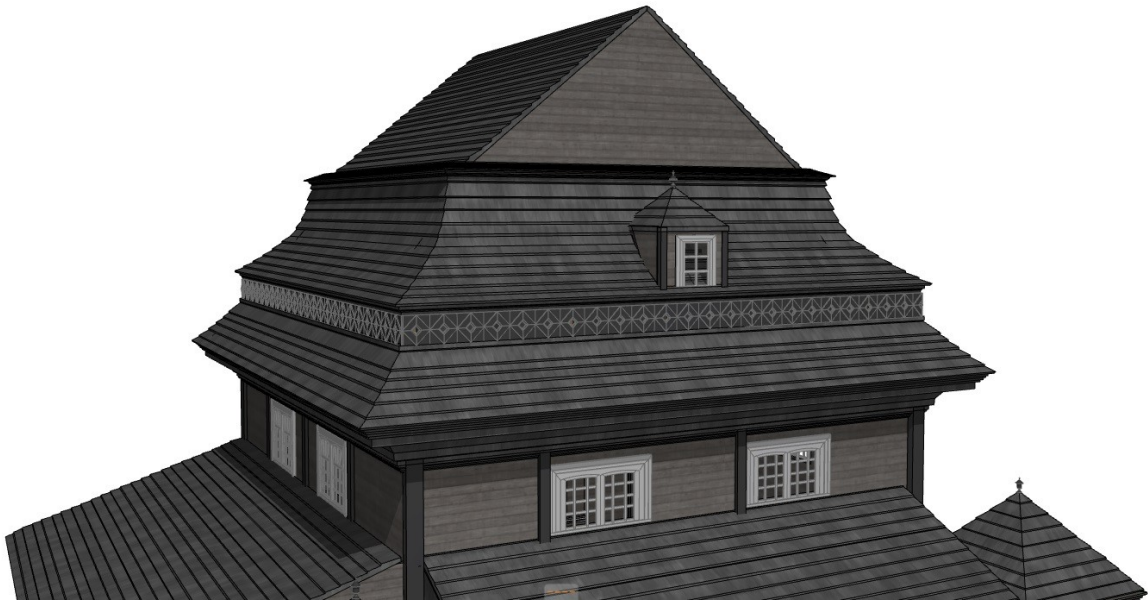

Fig. 49 2_main hall roof_3D view.jpg



Fig. 50 2_main hall roof_front view.jpg



Fig. 51 2_main hall roof_side view.jpg

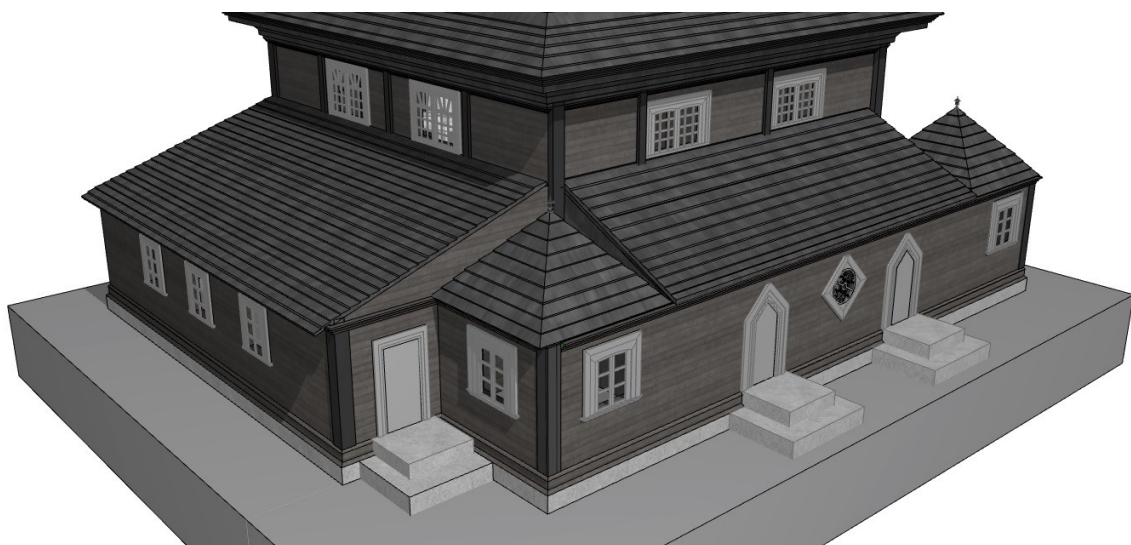

Fig. 53 2_first floor roofing_3D view.jpg

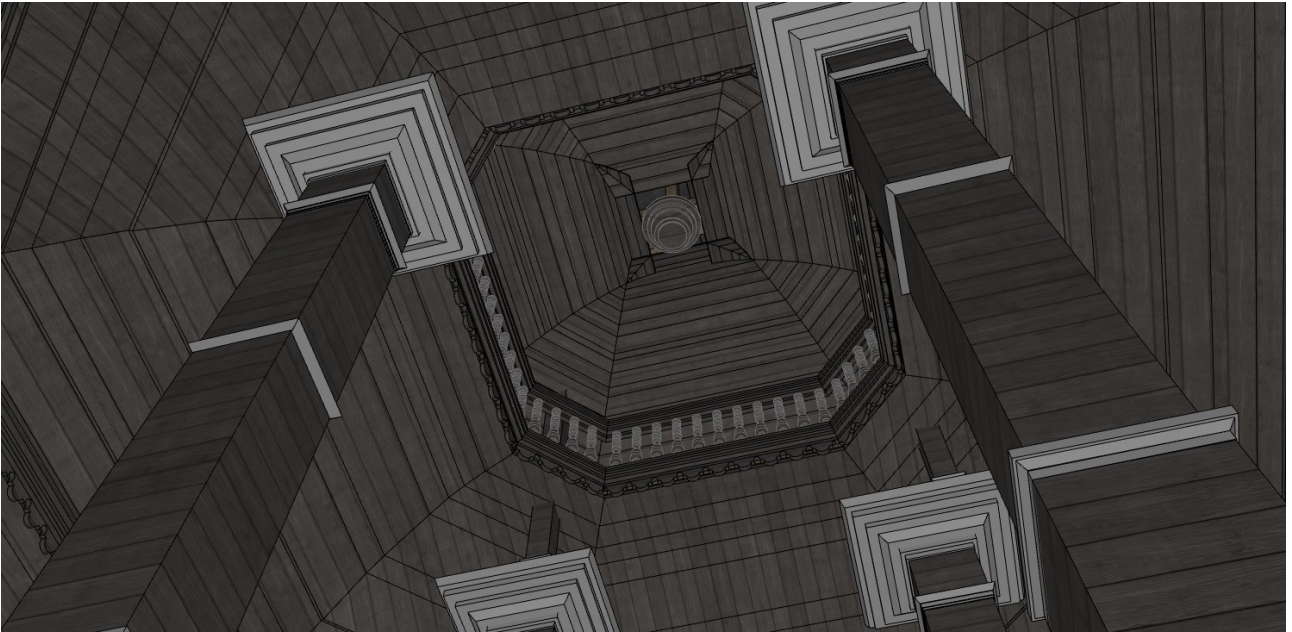

Fig. 54 2_vault_view.jpg



Fig. 55 2_main hall roof_3D view_section.jpg

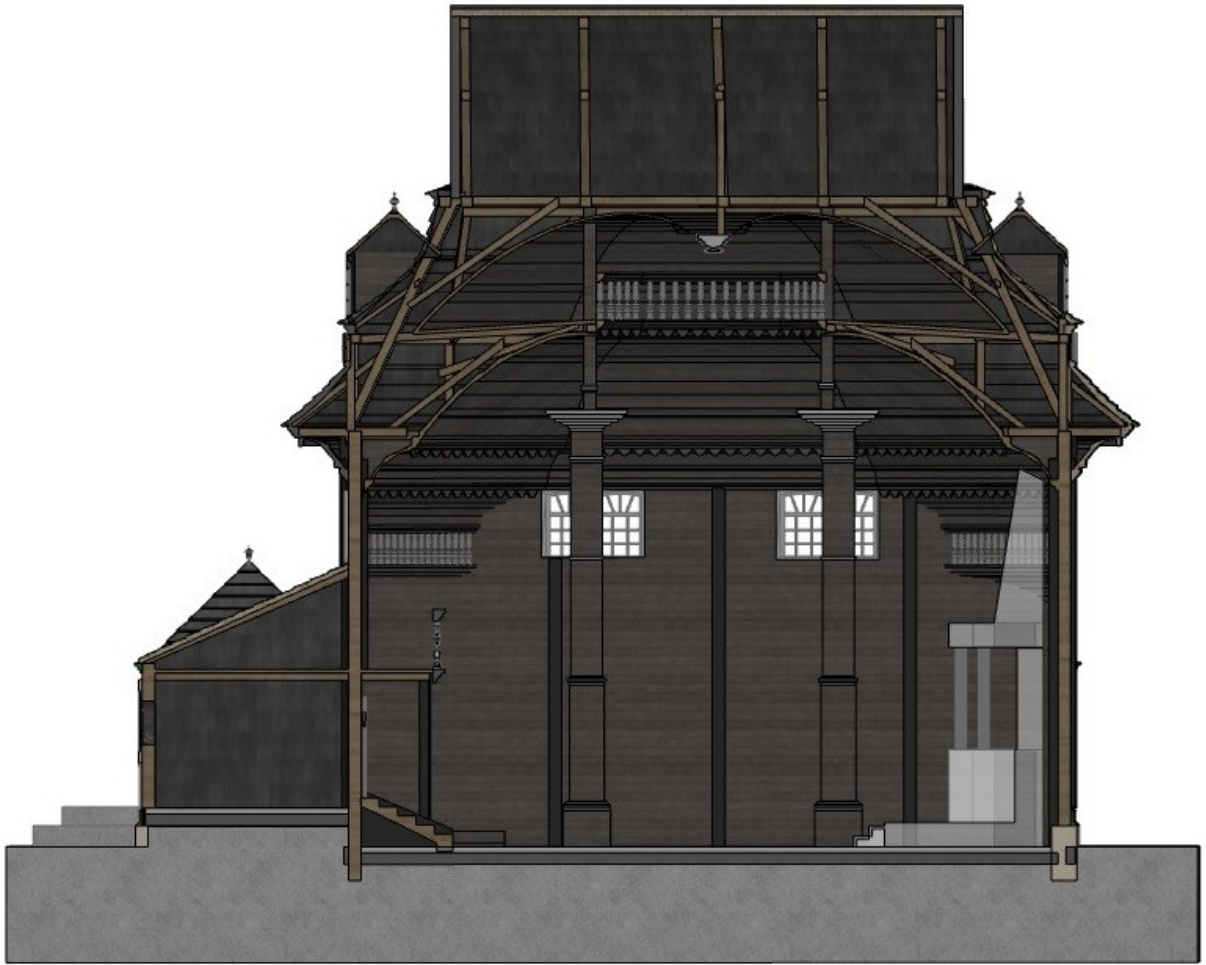

Fig. 56 2_section_with south wall in view.jpg

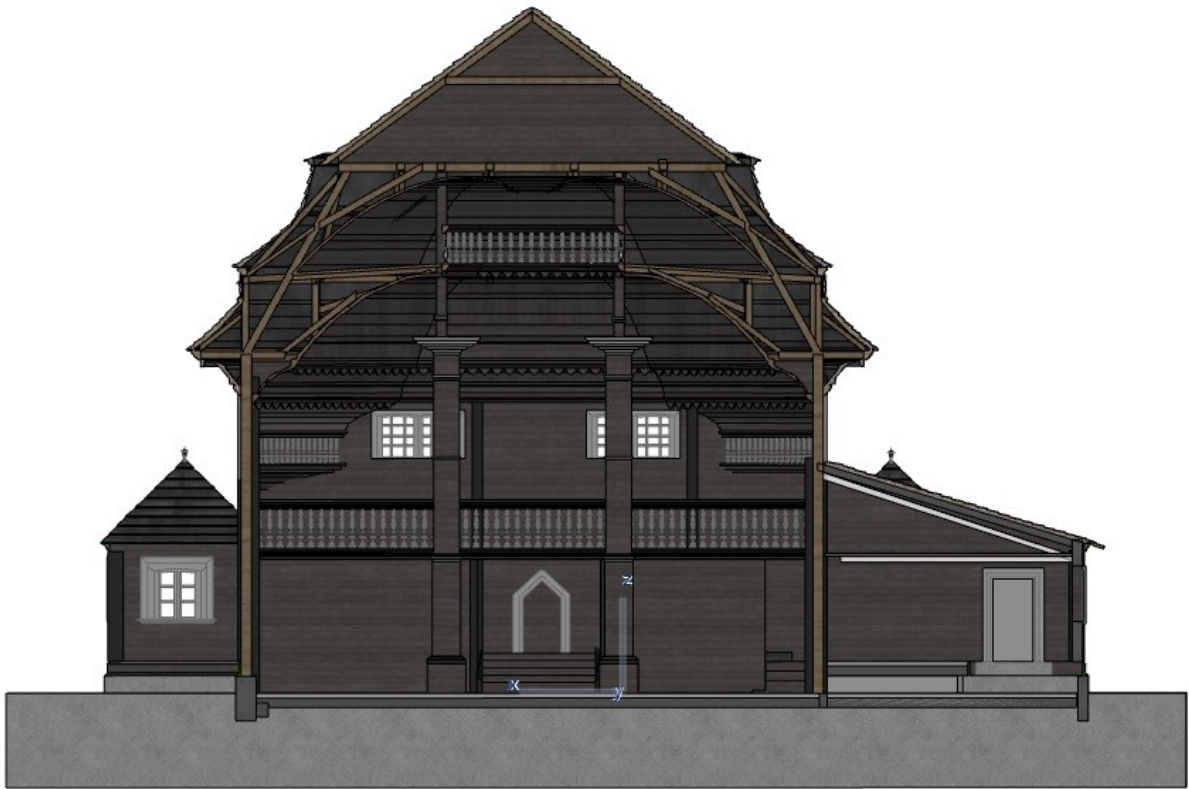

Fig. 57 2_section_with west wall in view.jpg

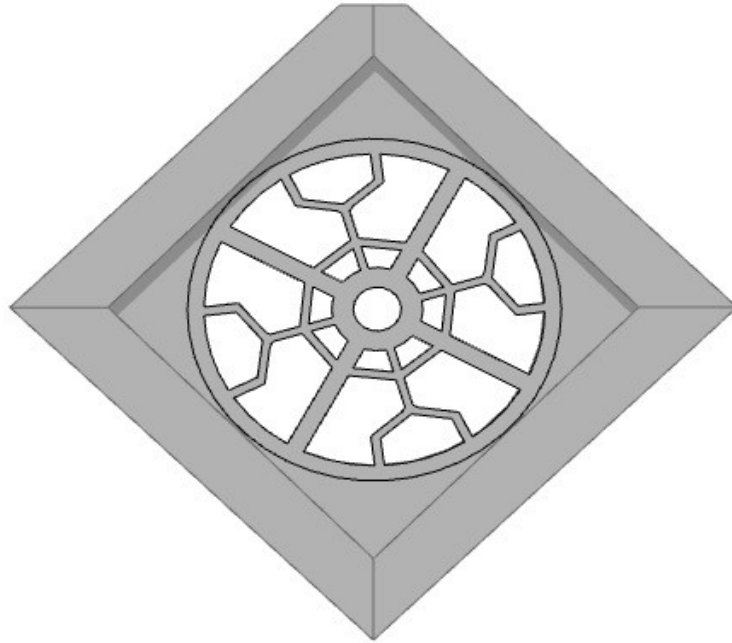

Fig. 58 2_round window_front facade.jpg

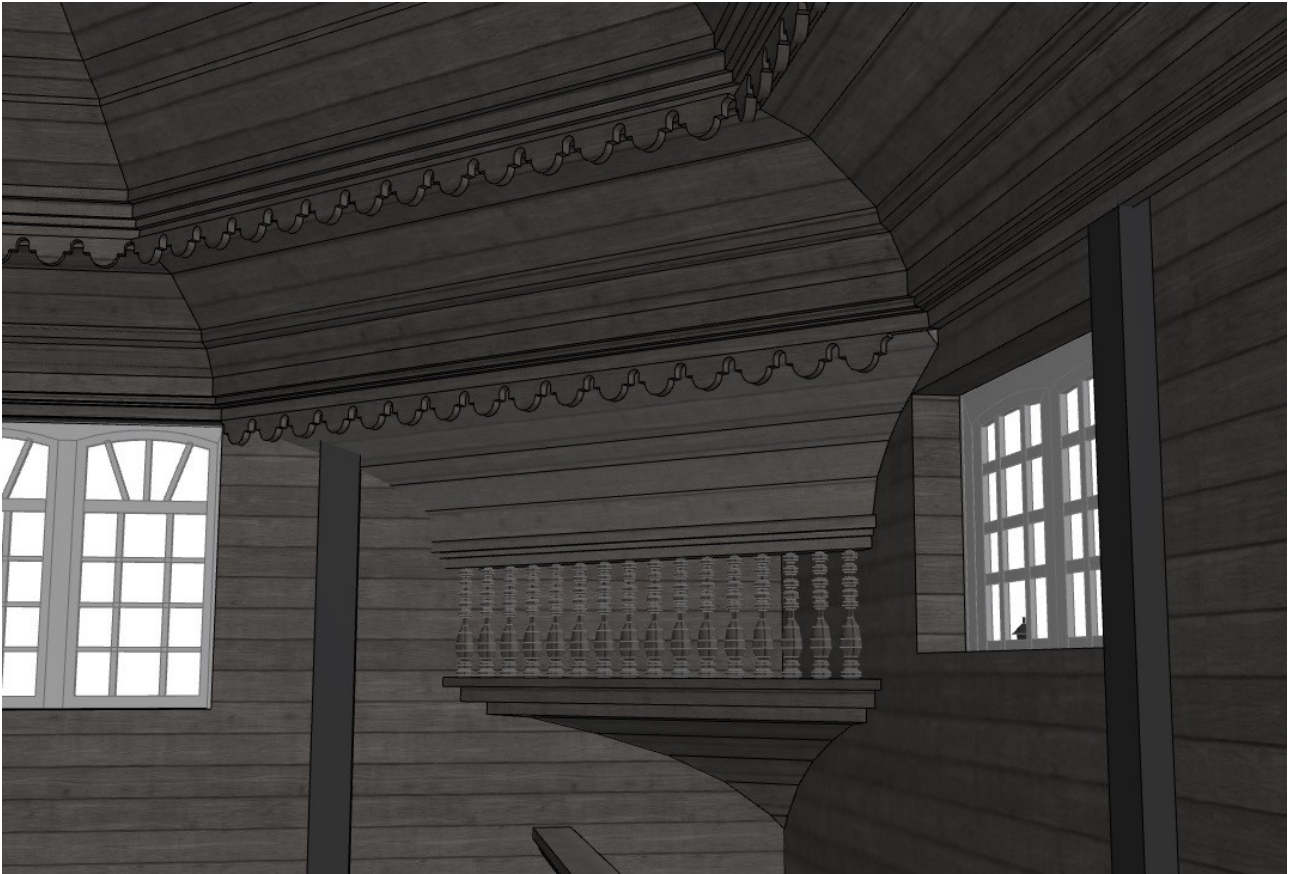

Fig. 59 2_squinches_3D view.jpg



Fig. 60 2_Friezes.jpg

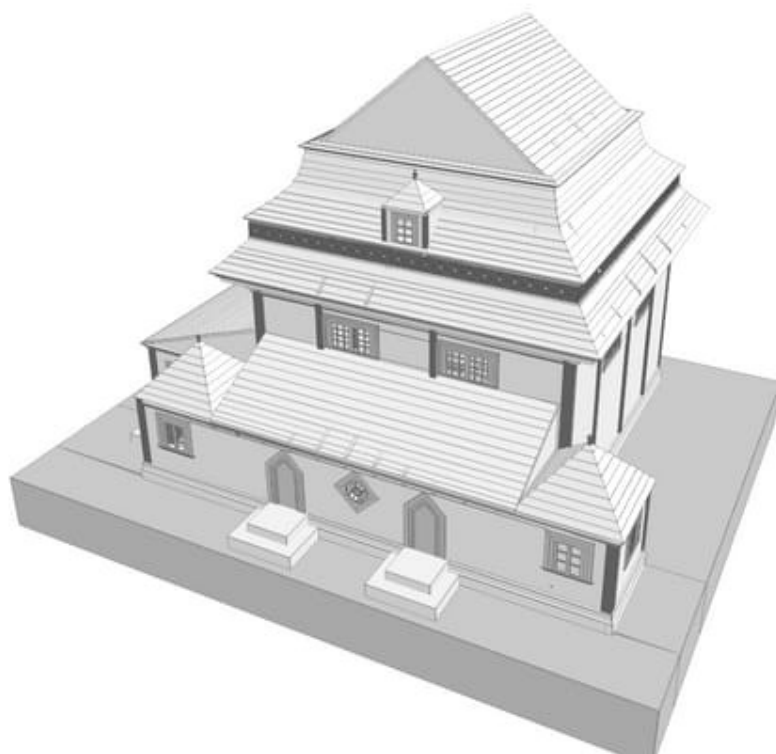

Fig. 62 Olkienniki_23.06.dae

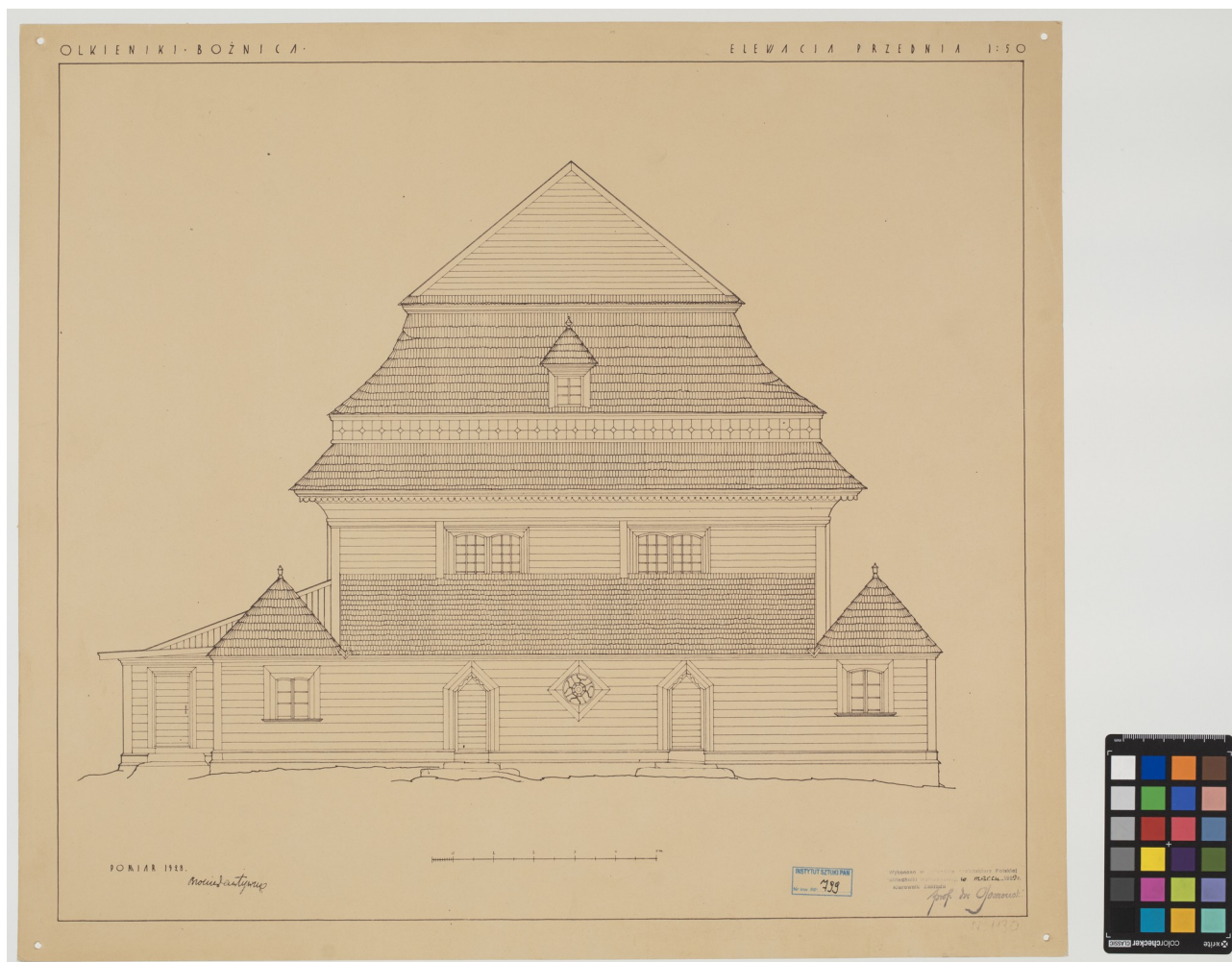

Fig. 1 IS_PAN_RP799_Olkieniki

Type	Drawn Reconstruction	Used in:
Description	Front (west) elevation	Roof
Author	Bronisław Żywno	
Archive	Instytut Sztuki PAN	
Signature	IS_PAN_RP799_Olkieniki	Windows
Copyright	IN COPYRIGHT - EDUCATIONAL USE PERMITTED	Doors
		Stairs
		Decorative elements

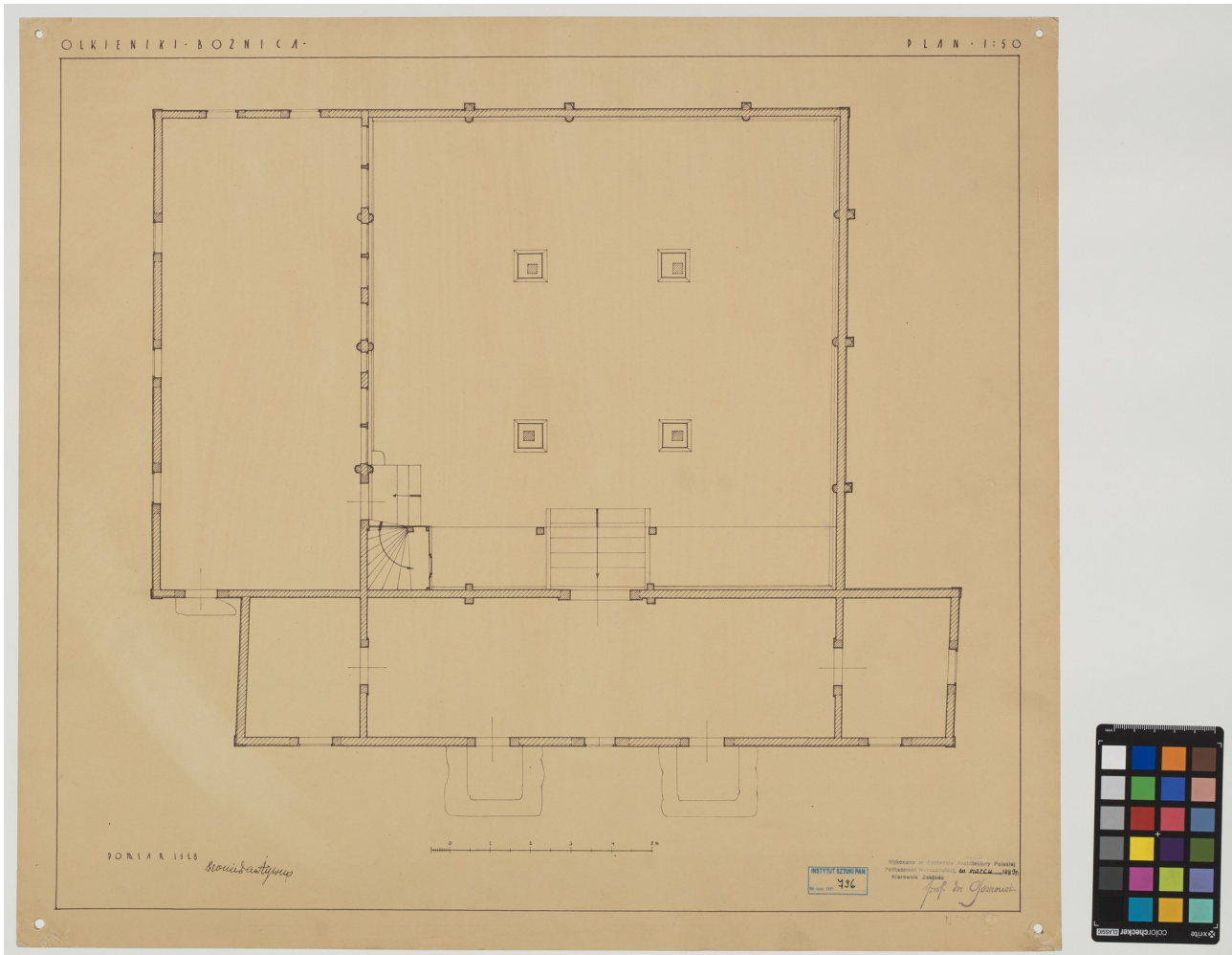

Fig. 2 IS_PAN_RP796_Olkieniki

Type	Drawn Reconstruction	Used in:
Description	Floor plan	Walls
Author	Bronisław Żywno	Stairs
Archive	Instytut Sztuki PAN	
Signature	IS_PAN_RP796_Olkieniki	
Copyright	IN COPYRIGHT - EDUCATIONAL USE PERMITTED	

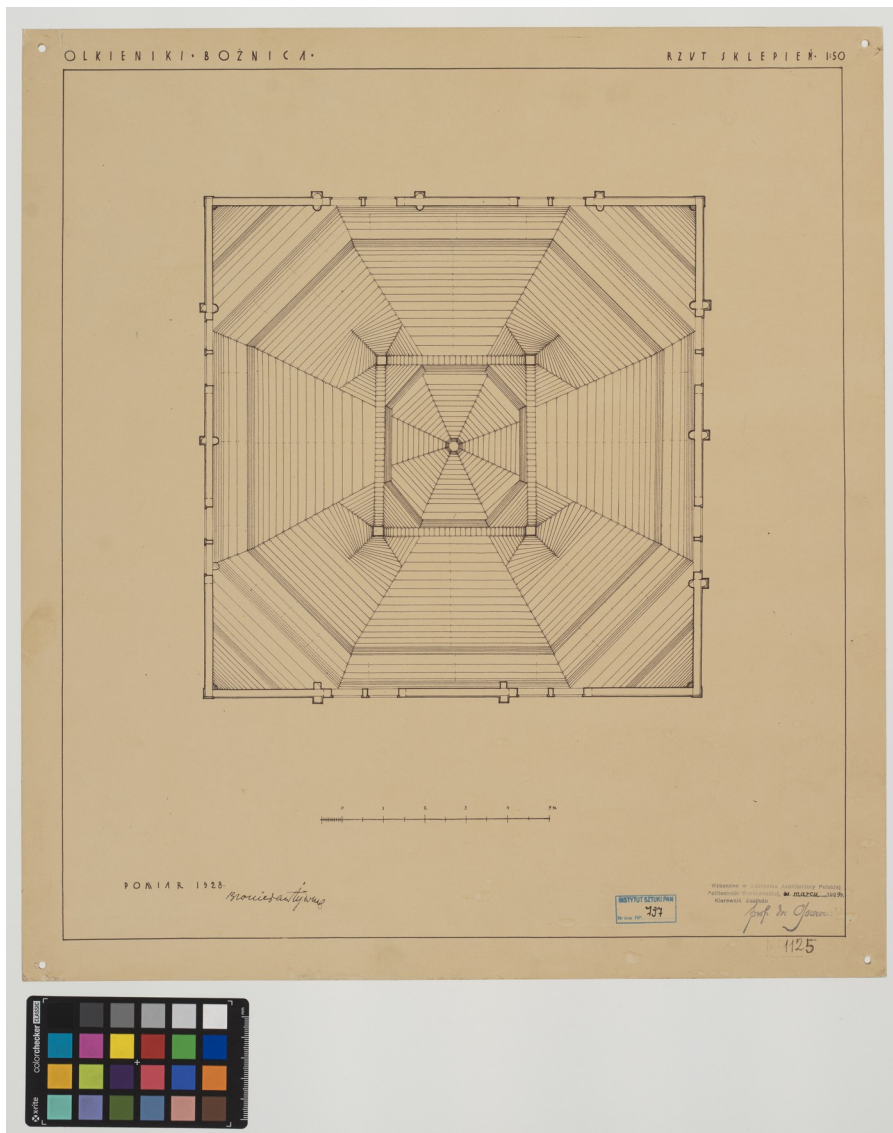

Fig. 3 IS_PAN_RP797_Olkieniki

Type	Drawn Reconstruction	Used in:
Description	Vault plan	Roof
Author	Bronisław Żywno	
Archive	Instytut Sztuki PAN	Ceiling
Signature	IS_PAN_RP797_Olkieniki	
Copyright	IN COPYRIGHT - EDUCATIONAL USE PERMITTED	

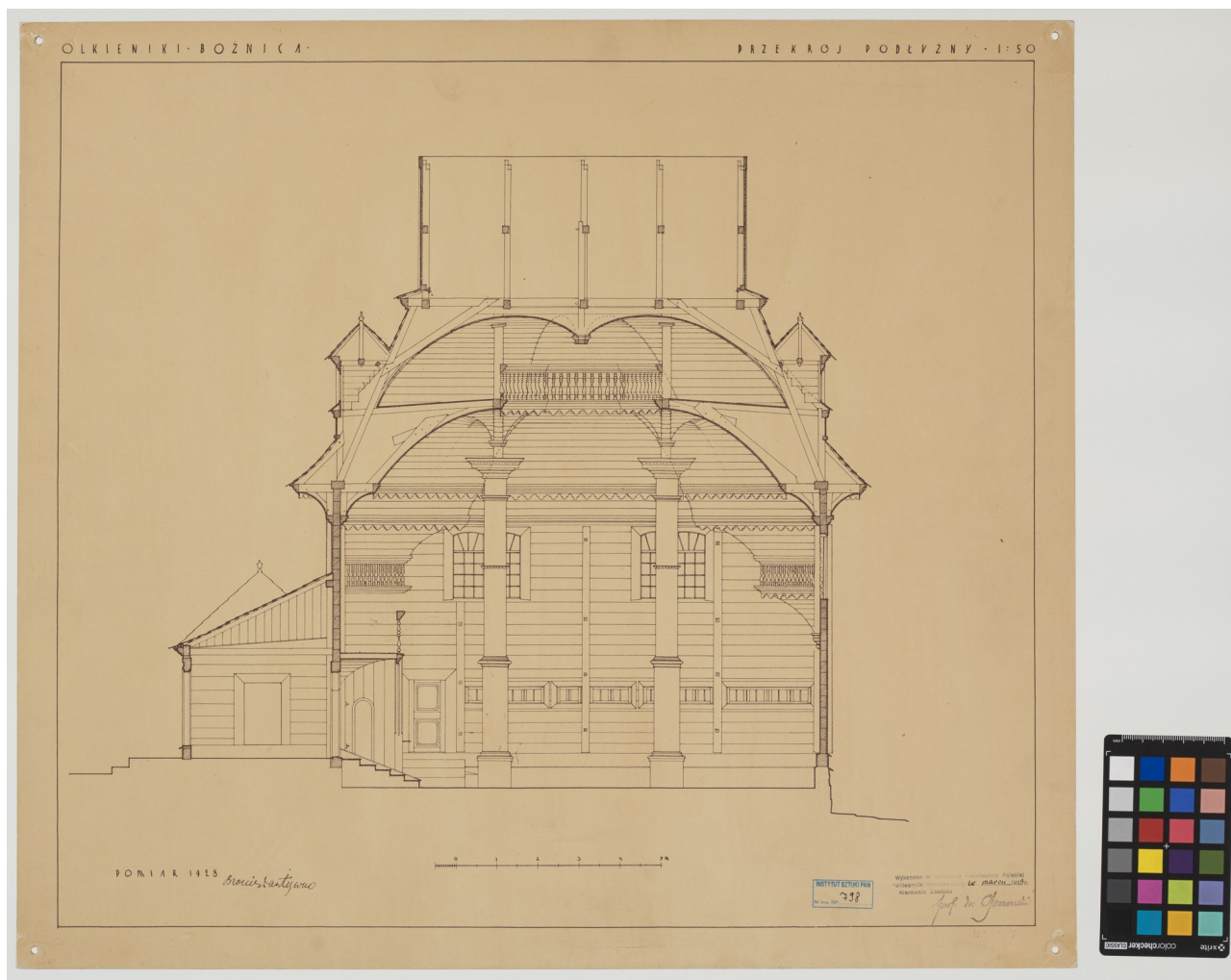

Fig. 4 IS_PAN_RP798_Olkieniki

Type	Drawn Reconstruction	Used in:
Description	Cross-section with the northern wall in view	Roof
Author	Bronisław Żywno	
Archive	Instytut Sztuki PAN	Walls
Signature	IS_PAN_RP797_Olkieniki	
Copyright	IN COPYRIGHT - EDUCATIONAL USE PERMITTED	Posts
		Doors
		Decorative elements

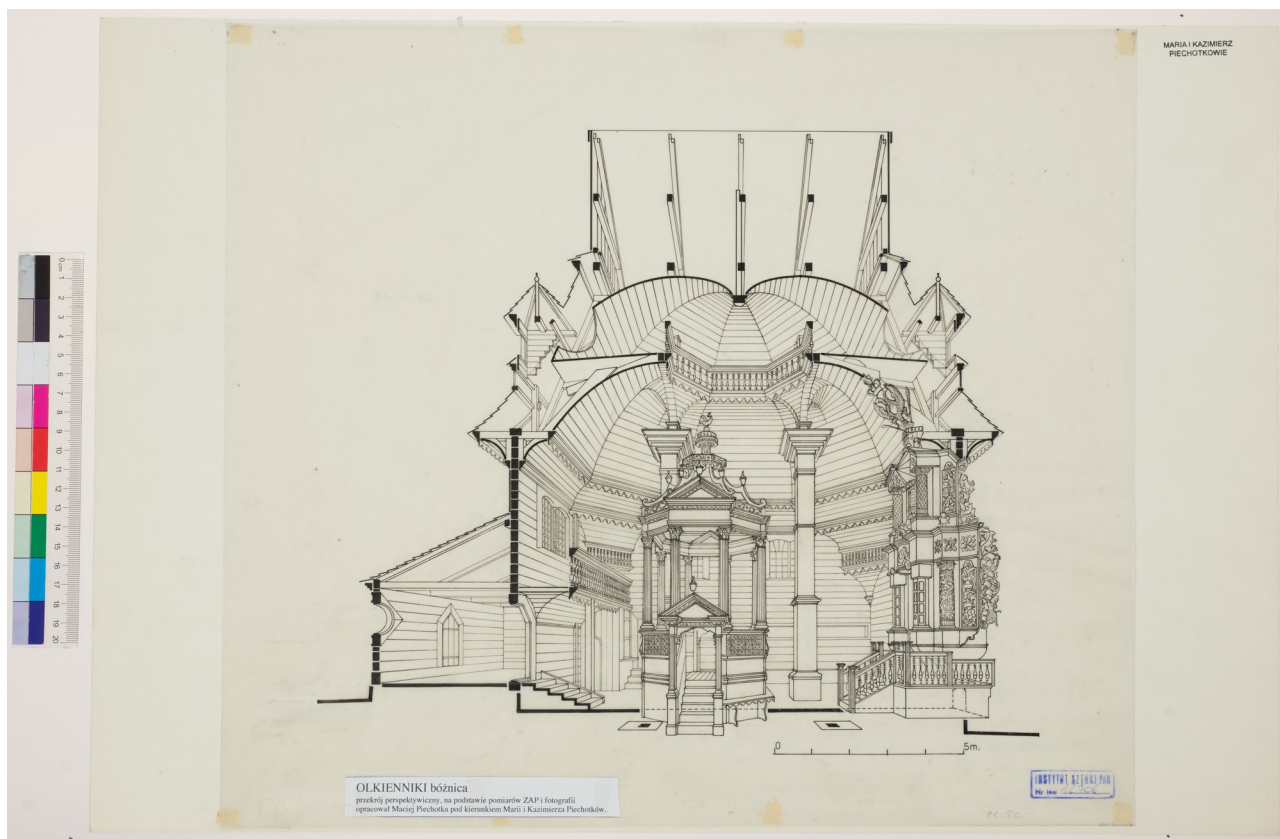

Fig. 5 IS_PAN_RP12706_Olkieniki

Type	Drawn Reconstruction	Used in:
Description	Perspective cross-section with the northern wall in view	Roof
Author	Maciej Piechotka	Ceiling
Archive	Instytut Sztuki PAN	Walls
Signature	IS_PAN_RP12706_Olkieniki	Posts
Copyright	IN COPYRIGHT - EDUCATIONAL USE PERMITTED	Doors
		Stairs
		Decorative elements
		Religious elements

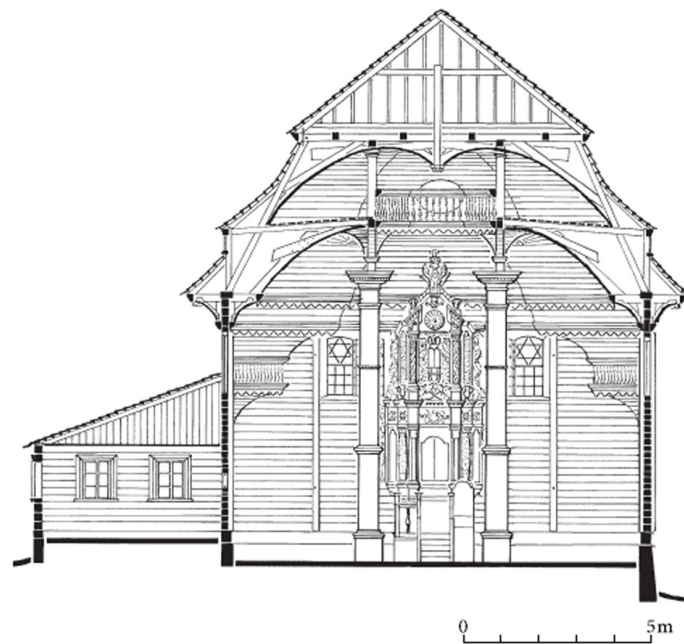

Fig. 6 533. Olkieni. Section looking towards the east wall

Type	Drawn Reconstruction	Used in:
Description	Transverse section looking towards the east wall; drawn by W. Olkowski on the basis of measurements ZAP and photographs.	Roof
Author	Wojciech Olkowski	Walls
Archive	Zakład Architektury Polskiej WAPW	Windows
Signature		
Copyright	IN COPYRIGHT - EDUCATIONAL USE PERMITTED	Decorative elements
		Religious elements



Fig. 7 536. Olkieniki. Interior of the cupola and the bimah canopy

Type	Photograph	Used in:
Description	Interior of the cupola and the bimah canopy, before 1939	Roof
Author	S. Zajczyk	Ceiling
Archive	Instytut Sztuki PAN	
Signature		
Copyright	IN COPYRIGHT - EDUCATIONAL USE PERMITTED	



Fig. 8 74. Olkieniki. Interior of the cupola

Type	Photograph	Used in:
Description	Interior of the cupola, before 1939	Ceiling
Author	S. Zajczyk	Posts
Archive	Instytut Sztuki PAN	Decorative elements
Signature		
Copyright	IN COPYRIGHT - EDUCATIONAL USE PERMITTED	



Fig. 9 127. Olkieni. Holy Ark, the upper section

Type	Photograph	Used in:
Description	Holy Ark, the upper section before 1939	Windows
Author	S. Zajczyk	Religious elements
Archive	Instytut Sztuki PAN	
Signature		
Copyright	IN COPYRIGHT - EDUCATIONAL USE PERMITTED	



Fig. 10 128. Olkieniki. Holy Ark, the lower section

Type	Photograph	Used in:
Description	Holy Ark, the lower section before 1939	Decorative elements
Author	S. Zajczyk	Religious elements
Archive	Instytut Sztuki PAN	
Signature		
Copyright	IN COPYRIGHT - EDUCATIONAL USE PERMITTED	



Fig. 11 177,178. Olkieni, Bimah, before 1939

Type	Photograph	Used in:
Description	Canopy of the bimah and entrance to the bimah	Ceiling
Author	S. Zajczyk	Walls
Archive	Instytut Sztuki PAN	Posts
Signature		
Copyright	IN COPYRIGHT - EDUCATIONAL USE PERMITTED	

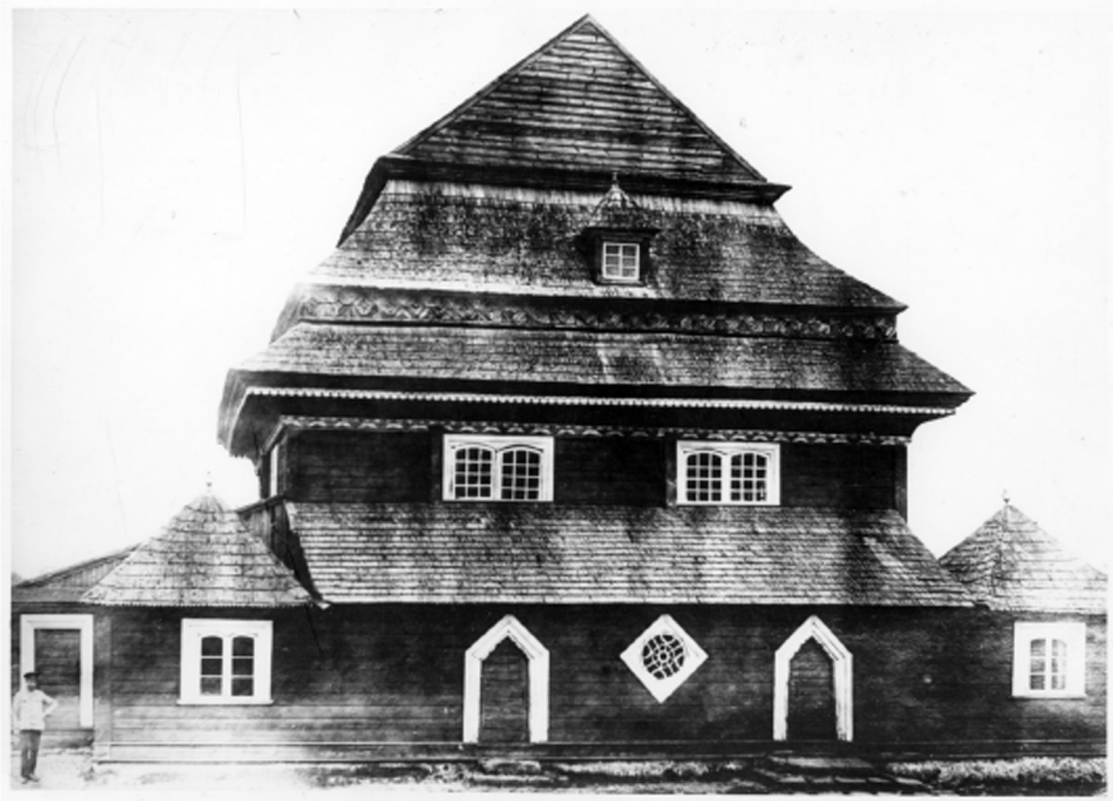

Fig. 12 528. Olkieniki. View from west

Type	Photograph	Used in:	
Description	View from west		Roof
Author	H. Struck		
Archive	Instytut Sztuki PAN		
Signature			Windows
Copyright	IN COPYRIGHT - EDUCATIONAL USE PERMITTED		Doors
			Decorative elements

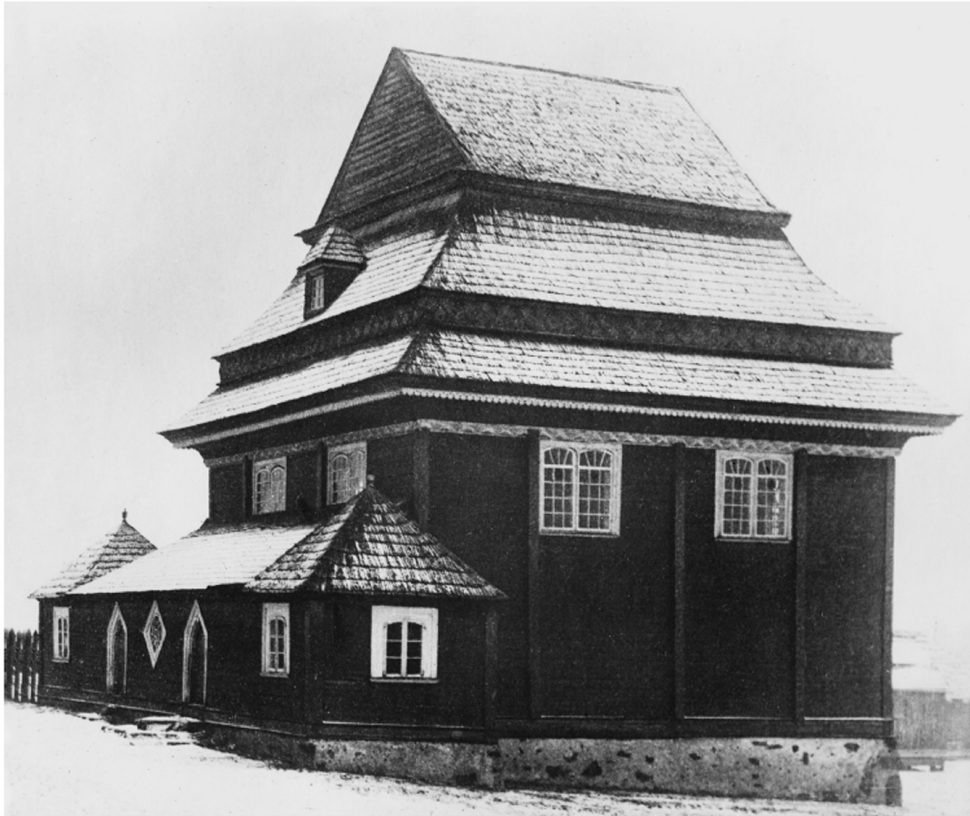

Fig. 13 529. Olkieniki. View from the south-west

Type	Photograph	Used in:
Description	View from the south-west, before 1939	Roof
Author	S. Zajczyk	
Archive	Instytut Sztuki PAN	Decorative elements
Signature		
Copyright	IN COPYRIGHT - EDUCATIONAL USE PERMITTED	



Fig. 14 532. Olkieniki. View from the east

Type	Photograph	Used in:
Description	View from the east, before 1939	Roof
Author	S. Zajczyk	
Archive	Instytut Sztuki PAN	Walls
Signature		
Copyright	IN COPYRIGHT - EDUCATIONAL USE PERMITTED	Windows
		Decorative elements

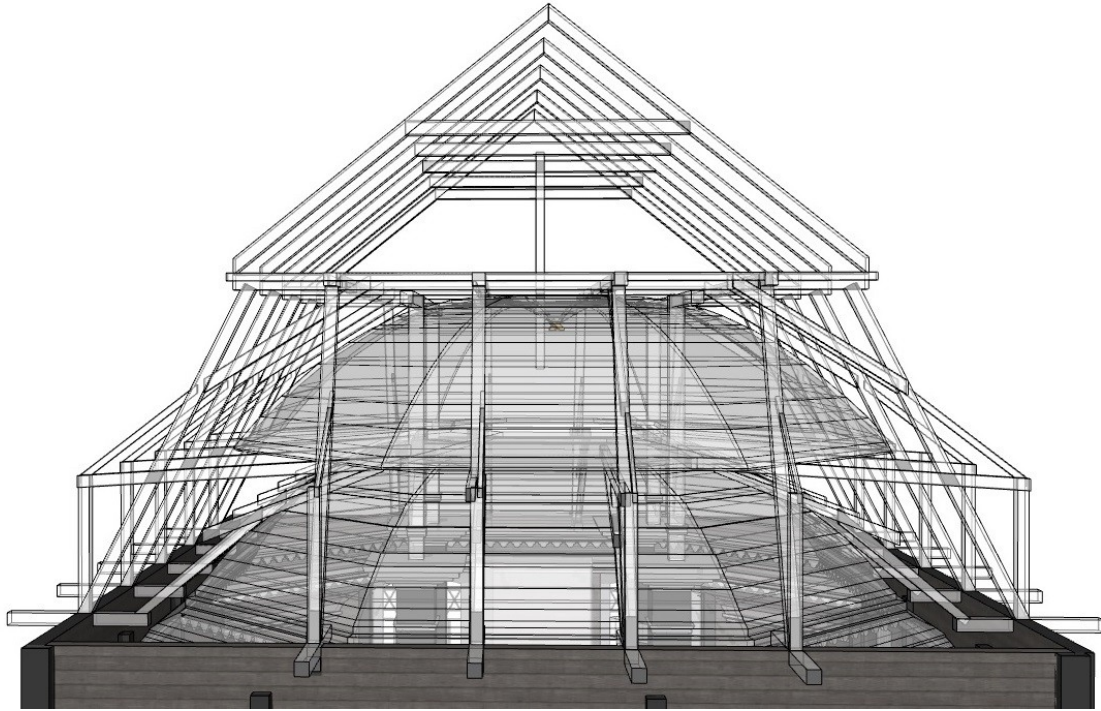

Fig. 16 Truss Roofing

Type
Description
Author
Archive
Signature
Copyright

Used in:

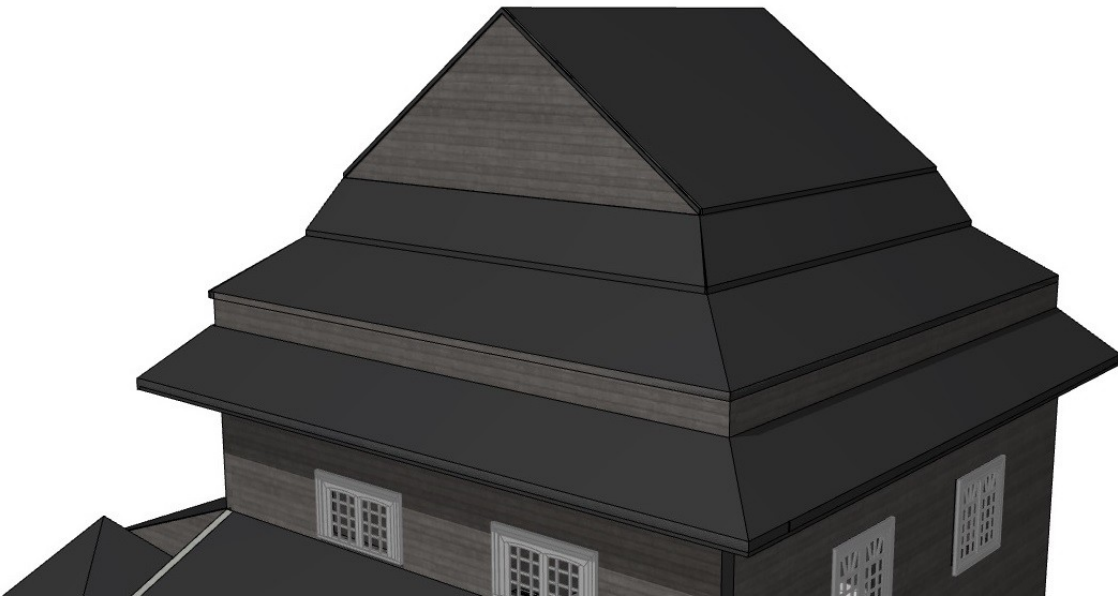

Fig. 19 Main hall roof

Type
Description
Author
Archive
Signature
Copyright

Used in:

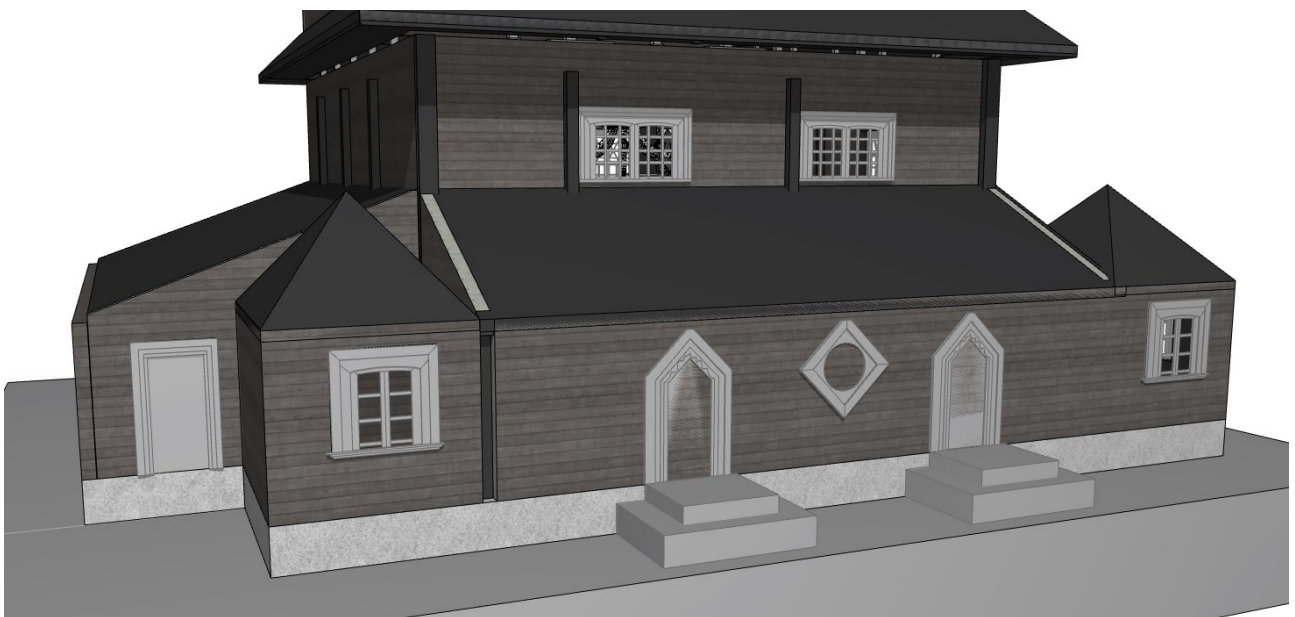

Fig. 23 Pitched Roof

Type

Used in:

Description

Author

Archive

Signature

Copyright

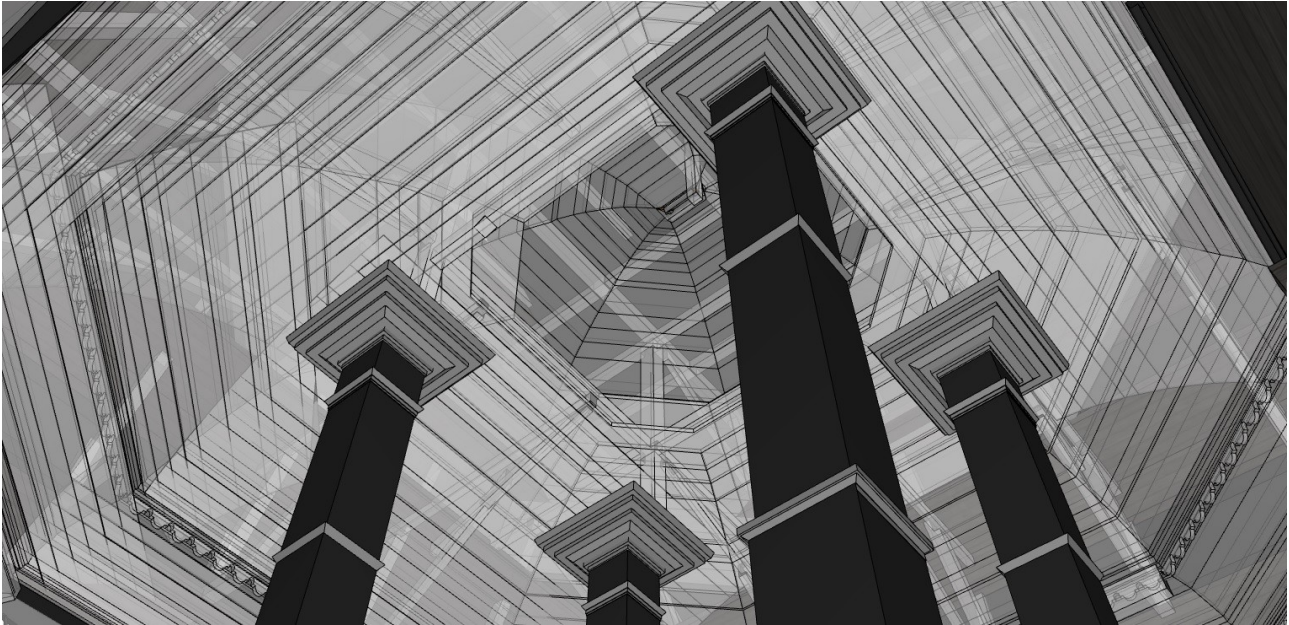

Fig. 25 Vault

Type

Used in:

Description

Author

Archive

Signature

Copyright



Fig. 29 Columns

Type

Used in:

Description

Author

Archive

Signature

Copyright

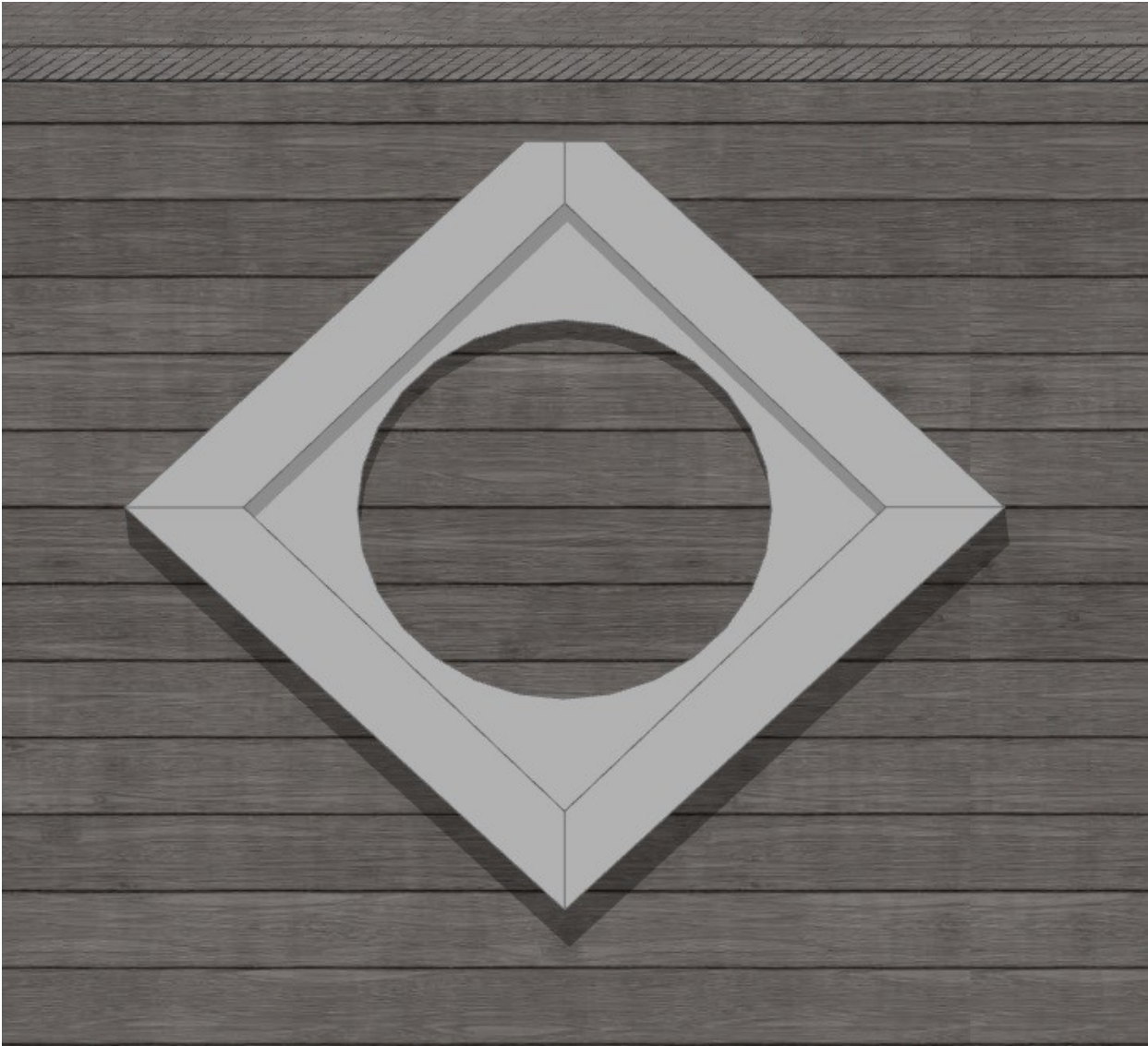

Fig. 33 Round windows

Type
Description
Author
Archive
Signature
Copyright

Used in:

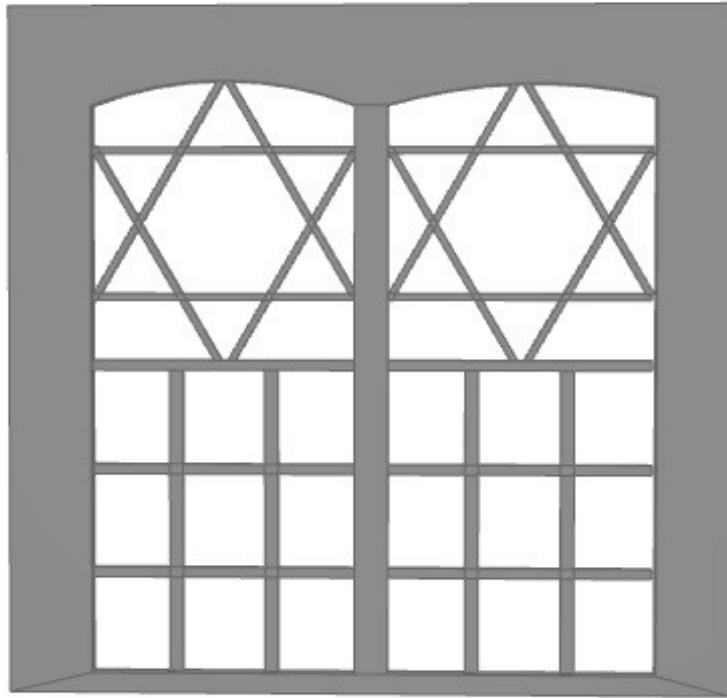

Fig. 35 Biforate windows

Type
Description
Author
Archive
Signature
Copyright

Used in:

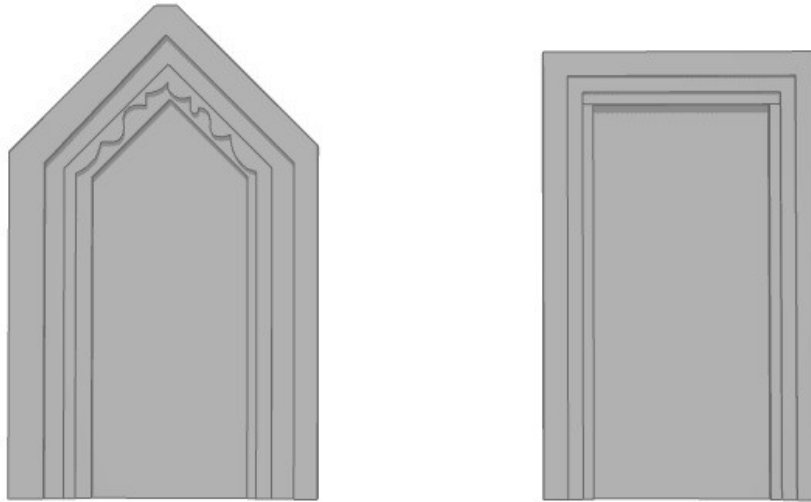

Fig. 38 Doors

Type

Used in:

Description

Author

Archive

Signature

Copyright

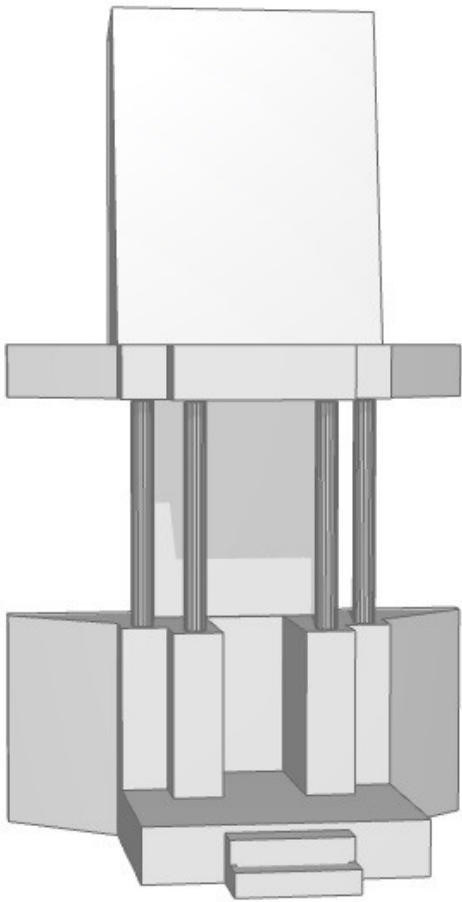

Fig. 40 Holy Ark

Type

Description

Author

Archive

Signature

Copyright

Used in:

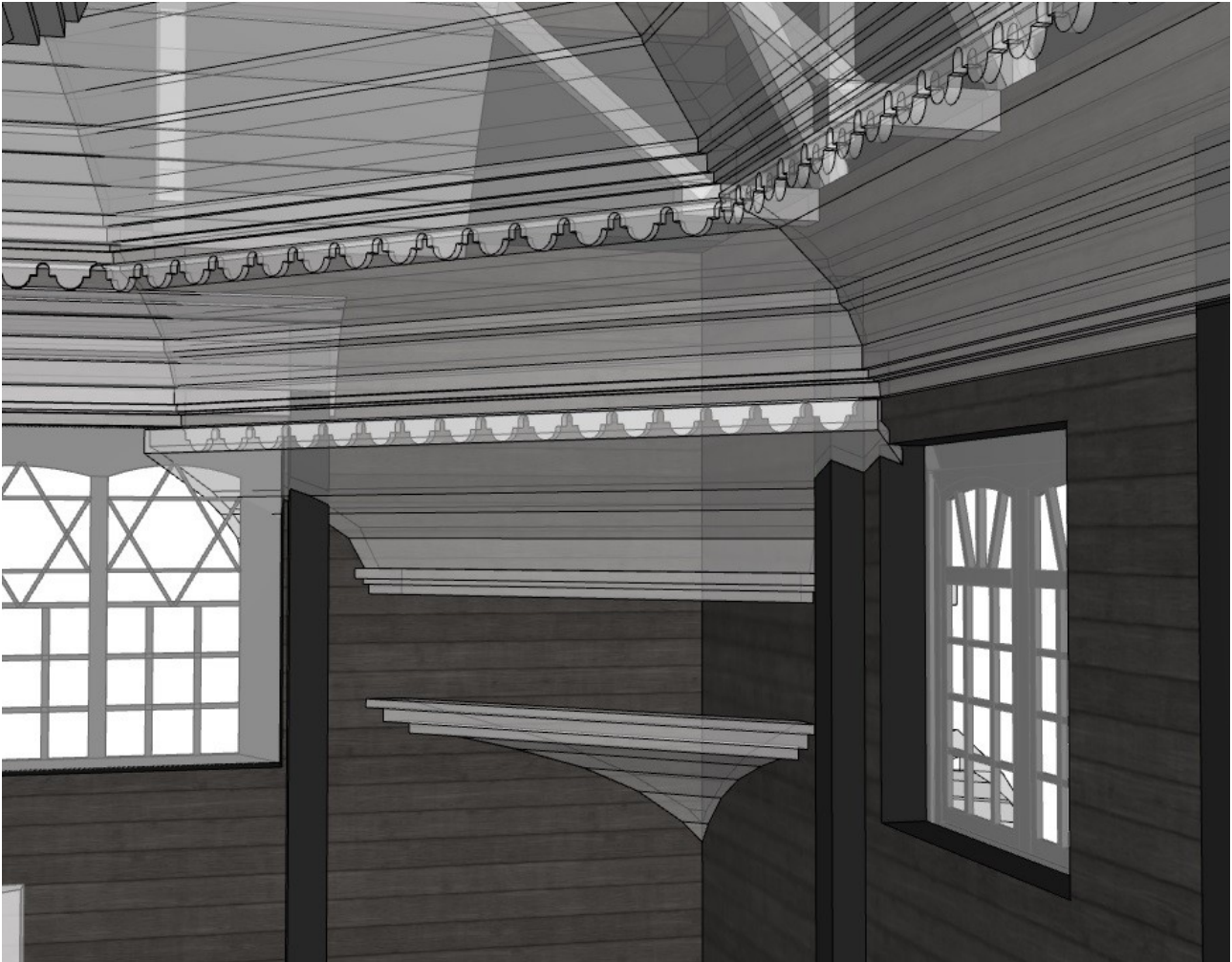

Fig. 43 Squinches

Type
Description
Author
Archive
Signature
Copyright

Used in:



Fig. 44 Balustrades and railings

Type	Used in:
Description	
Author	
Archive	
Signature	
Copyright	

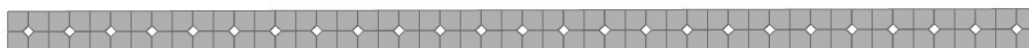

Fig. 46 Friezes

Type	Used in:
Description	
Author	
Archive	

Signature

Copyright

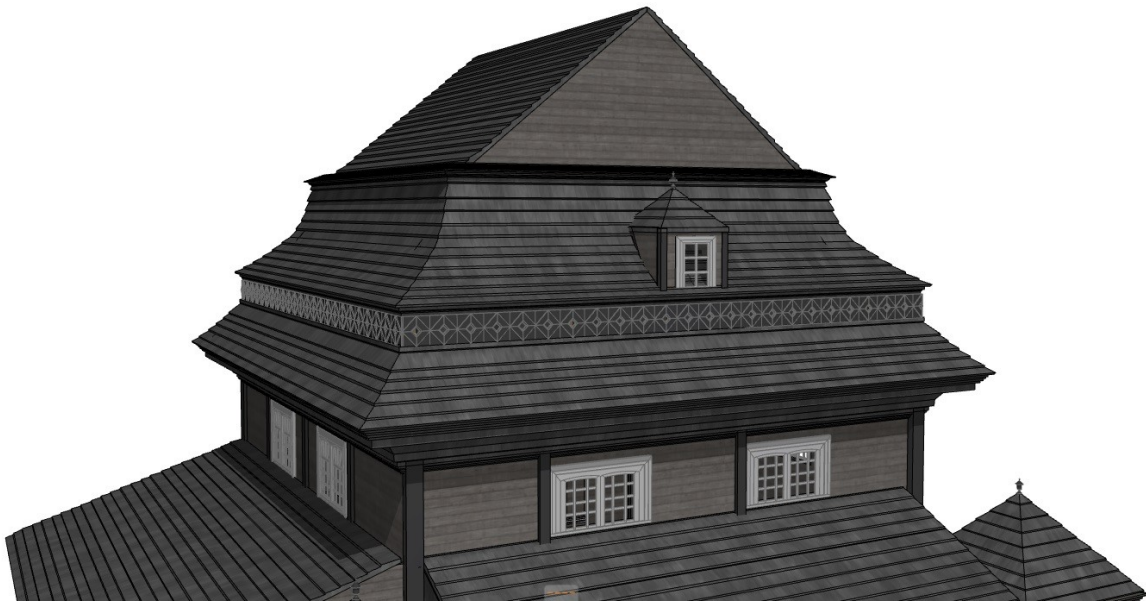

Fig. 52 Main hall roof

Type

Used in:

Description

Author

Archive

Signature

Copyright